

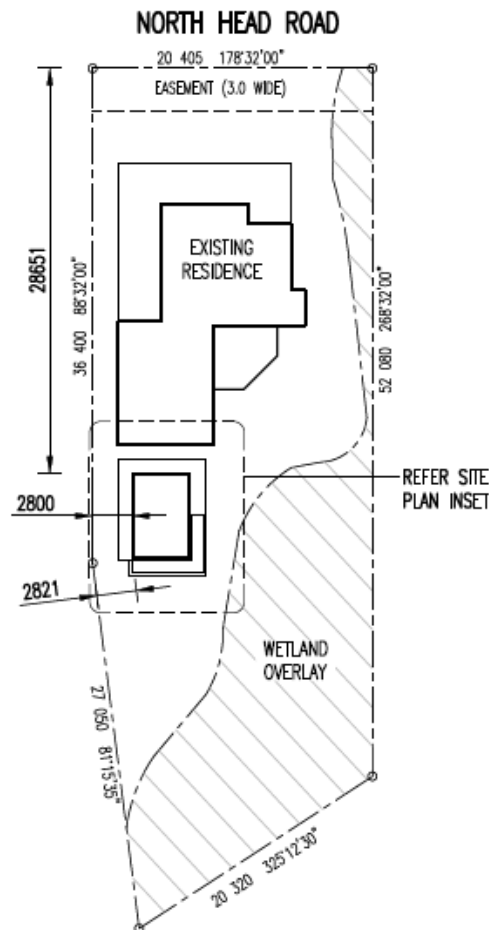

Living Pools & Spas Pty Ltd
ABN 15 661 498 148
NSW License 391020C
PO Box 95 Bangalow NSW 2481
livingpools.au

Construction Management Plan & Sediment Erosion Plan– Proposed Swimming Pool & Timber Decking
Lot 4 DP 1035885
32 North Head Road. New Brighton. NSW

Proposed Pool Location:



SITE PLAN
SCALE 1:400



Proposed Works:

- Excavation of Swimming Pool – 3.5T Excavator.
- Installation of Screw Piers to Pool Foundations – 3.5T Excavator.
- Removal of Excavated Spoil from Site – Pozi-Track Skid Steer Loader (Kubota SVL72).
- Cartage of Excavated Spoil from Site – 10m Tipper Trucks.
- Delivery of Steel Reinforcing – to Front of the Property with a Crane Truck & Manually Handled to the Swimming Pool.
- Placement of Shotcrete Concrete – Line Pumped from front of Property.
- Delivery of Pool Tiles – to Front of Property with Moffett Truck Mounted Forklift to be Manually Handled to Swimming Pool.
- Delivery of Timber for Decking – to Front of the Property with a Crane Truck & Manually Handled to the Swimming Pool Construction Zone.
- Delivery of Pool Filtration Equipment – Tailgate Delivery to Front of Property and Manually Handled to Proposed Filtration Location.
- Installation of Pool Interior Lining – Pebble Interior Delivered in 20kg Bags and Manually Handled to the Swimming Pool Shell for Mixing and Installation.

Plan Objective:

Minimise Impacts of Construction Activities on:

- Wetland Overlay.
- Neighbours
- Users of Public Footpaths & Roads

Action Plan:

- Work Hours – 7am to 6pm Monday to Friday
 - 8am to 1pm Saturday
- Traffic – Vehicular Traffic to be kept to a minimum and Vehicles to be parked legally. No road closures or traffic control required.
- Wetland – The Swimming Pool Construction Zone will be marked out and barricaded so that:
 - There will be no dumping or storage of spoils, waste or other building materials in the Wetland Zone.
 - There will be no Temporary or Permanent Pool Fencing Constructed in the Wetland Zone.
 - There will be no access to Excavation or Other Vehicles in the Wetland Zone.
 - In Accordance with Sediment Erosion Plan, no Spoil, Waste, Rubbish & Soil will enter the Wetland Zone.

Sediment Erosion Plan:

Plan Objective:

Identify Erosion Risks & Determine Controls to be put in place to reduce/prevent Erosion & Sedimentation during the Construction of the Swimming Pool & Decking.

Action Plan:

- Earthworks – Installation of Screw Piers rather than Bored Concrete Piers will reduce the disruption to the site and amount of spoil to be removed.
- 1m Maximum Excavation to Minimise the Environmental Impact and Reduce Soil Erosion Risk.
- No Excavated Spoil will be Stock-Piled on site and specifically not in the Wetland Zone.
- Erosion Barriers – Sediment Barriers are to be set up in the Existing Lawn Area, between the Proposed Pool & the Wetland Zone.
- Sediment Barriers to be constructed as per Figure 1 below:

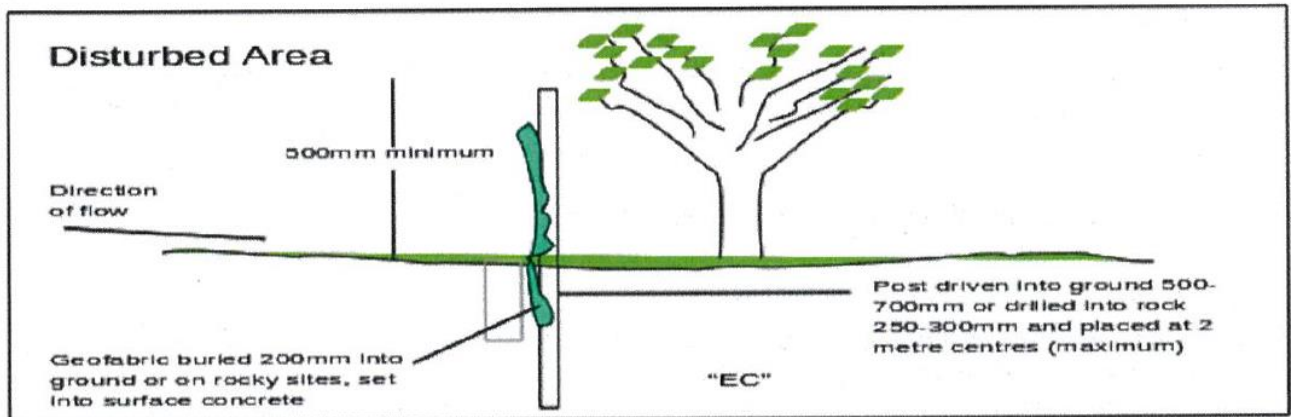

Figure 1: Construction of a geofabric-lined 'silt' fence

Notes:

These Plans are to be considered in conjunction with the:

- Statement of Environmental Effects Planning Report by Byron Bay Planning & Property Consultants (Dated 8th May 2023)
- Engineering Plans by Newport Engineering (Revision B. Dated 30th May 2023)
- Soil Test Report by ASCT (Dated 23rd March 2023)

Yours Truly,

Ben Salisbury
Company Director
5th June 2023.