

PROPERTY DESCRIPTION.
LOT 1 ON DP 923207.
PARISH OF BILLINUDGEL.
COUNTY OF ROUS.
LOCAL AUTHORITY. BYRON SHIRE COUNCIL.
SITE AREA. 100 ACRES. 40.47 HECTARES.

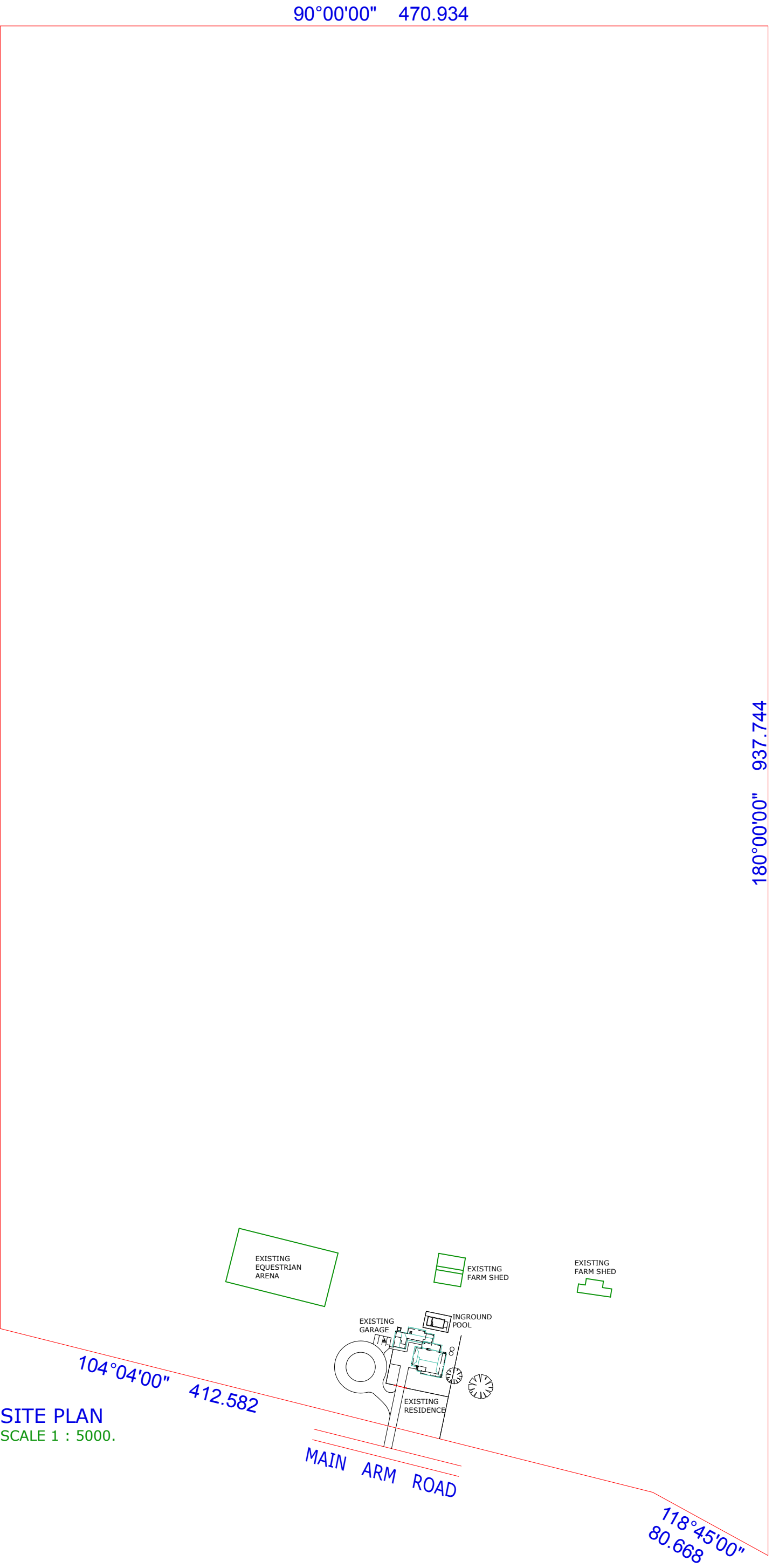

PART SITE PLAN
SCALE 1 : 400.

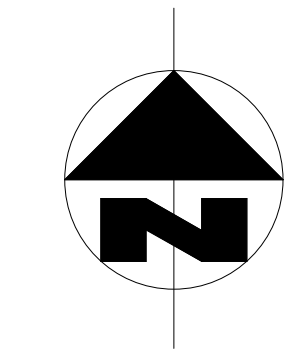
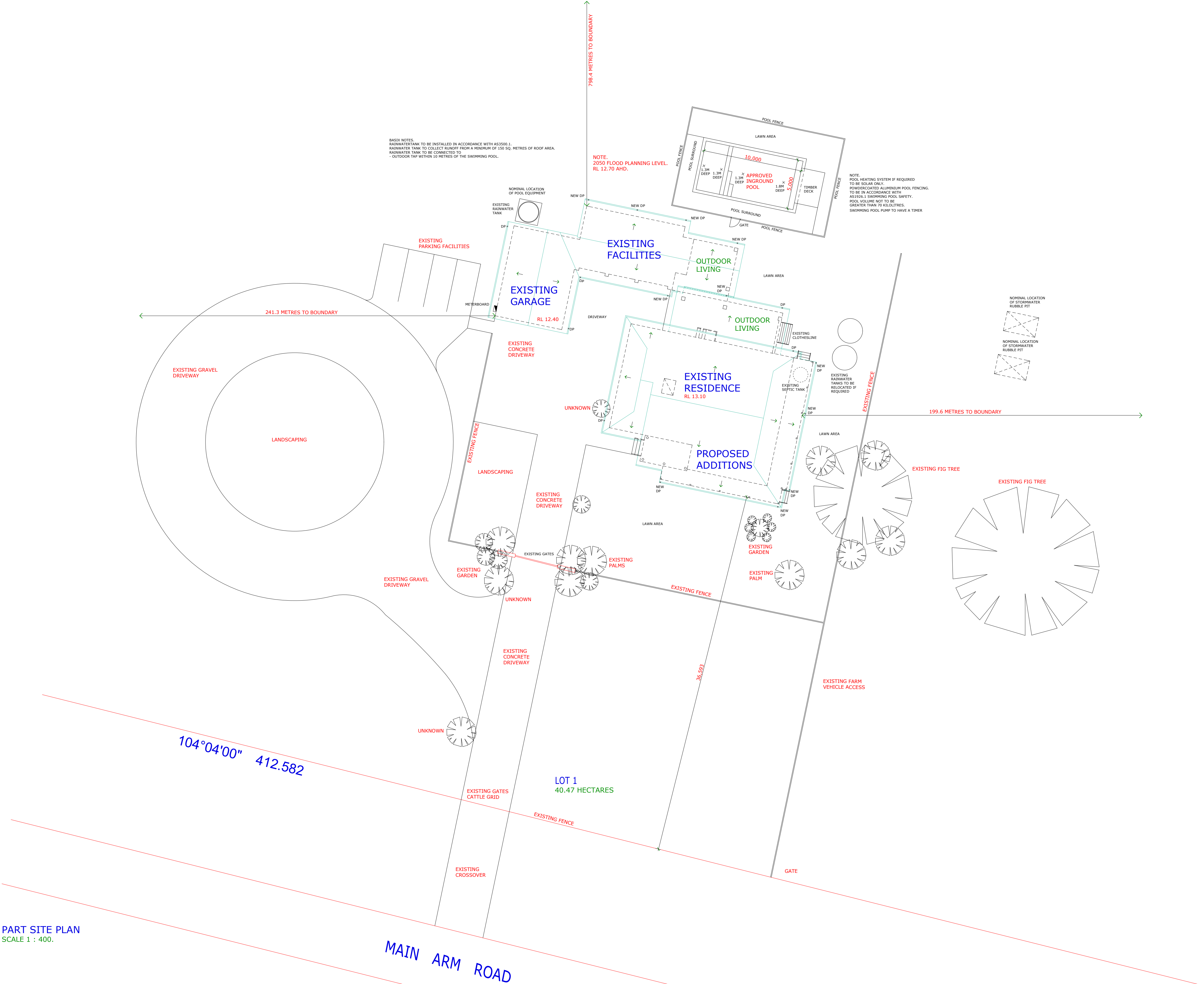

SITE PLAN
SCALE 1 : 200

AMENDMENTS.			
AMEND.	DATE.	INT.	DESCRIPTION.
AMEND A.	08.12.19.	D.C.	ISSUE FOR DEVELOPMENT APPLICATION APPROVAL.

PROJECT. **PROPOSED ALTERATIONS & ADDITIONS.**

AT. Lot 1. No. 256. Main Arm Road. Mullumbimby. NSW.

FOR. Ms Kristen Fleet.

Design & Documentation by Douglas Cope.
All building construction to comply with Local Authority By-Laws and the Building Code of Australia. Do Not Scale this Drawing, use given dimensions in preference. All dimensions and levels are to be confirmed Onsite. These drawings and the COPYRIGHT thereof are the property of Douglas Cope and must not be used or reproduced without the written permission of Douglas Cope. Professional Indemnity Insurance held individually by Douglas Cope.

DATE. DEC, 19

DRAWN. D.C.

SCALE. 1 : 200

DRAWING TITLE. **PART SITE PLAN.**

PROJECT No. **B1245** DWG No. **DA1**

QBSA Licence No. 1037753
ABN. 86 86 11 73 484

49 Kingsley Lane
Byron Bay NSW 2481

Ppdc
Mobile 0401 000126
Email doug@ppdc.com.au

prestigepropertiesdesign&construction
Development Consultants|Architectural Designers
RAIA 25222. QBSA Licence No. 1037753