

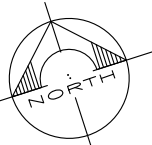

REV	REVISION DESCRIPTION	BY	DATE	THIS DRAWING IS CONFIDENTIAL AND IS THE PROPERTY OF GREG ALDERSON AND ASSOCIATES. IT MUST NOT BE DISCLOSED TO A THIRD PARTY, REPRODUCED, COPIED, OR LENT WITHOUT THE WRITTEN CONSENT OF THE PROPRIETOR.	GREG ALDERSON & ASSOCIATES ABN 58 594 160 789 43 Main Street CLUNES NSW 2480 Ph: 02 6629 1552 E: office@aldersonassociates.com.au Web: aldersonassociates.com.au	Client: VITALE PROPERTY GROUP PTY LTD Site address: 29 SHIRLEY STREET BYRON BAY NSW 2481	Title: WASTE VEHICLE ENTRY SWEPT PATH DRAWINGS Project: 29 SHIRLEY STREET UNIT DEVELOPMENT	FOR INFORMATION					
C	UPDATED VEHICLE DIMS	AB	29/07/2022					Drawn: AB	Scale: 1:250	Checked: AE	Original Size: A3	No. in set: 01 of 02	Date: 16/08/2022
D	UPDATED VEHICLE LENGTH	AB	16/08/2022										Revision: D
								DO NOT SCALE DRAWINGS, USE FIGURED DIMENSIONS					
								REFER COVER SHEET FOR NOTES UNLESS NOTED OTHERWISE					
Z:\JOBS\22\22381 - Vitale Property Group - 29 Shirley Street, Byron Bay\CIVIL\CAD\22381-CIV-SP-D.dwg													

MILTON STREET

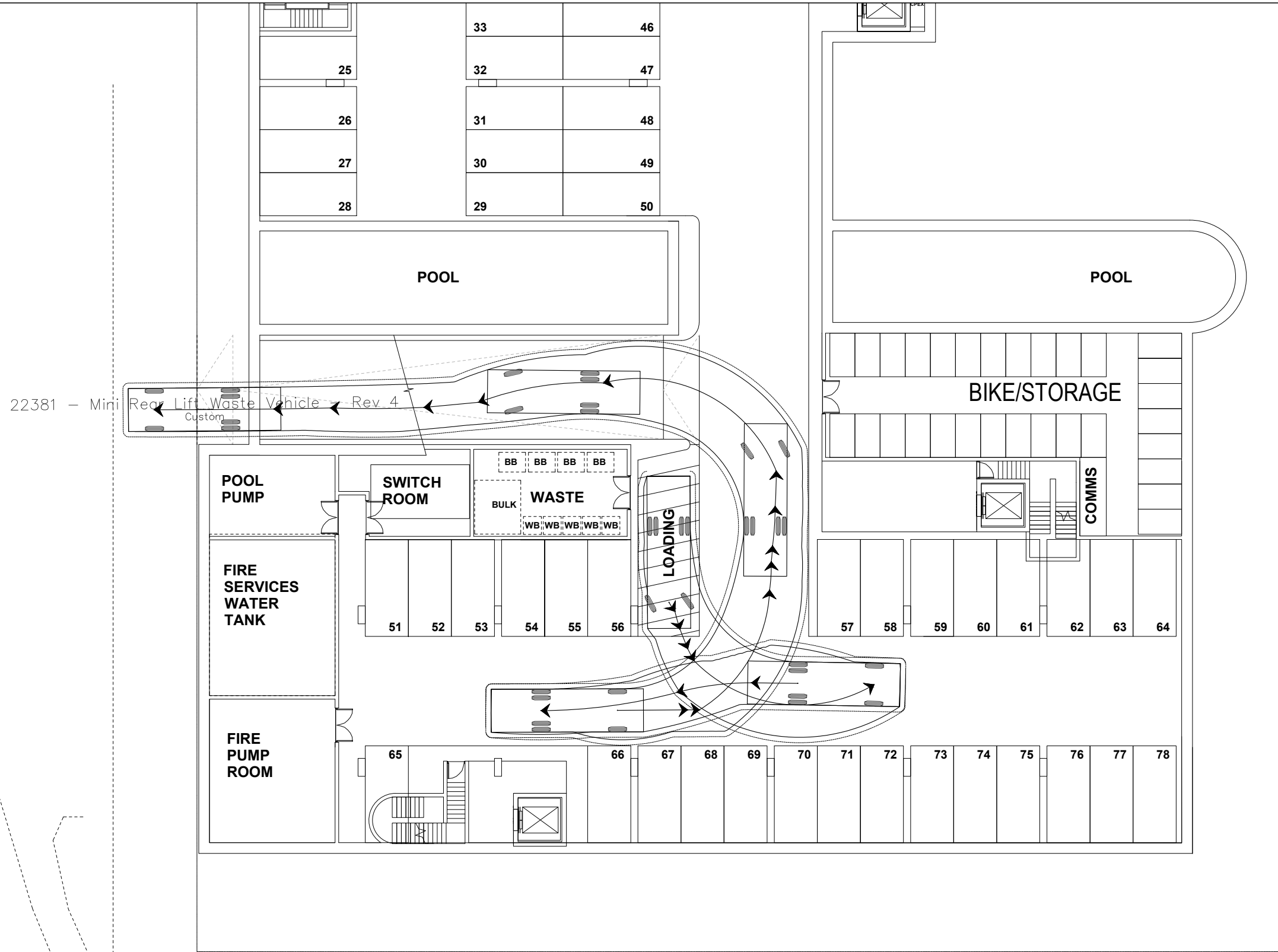

Approximate

REV	REVISION DESCRIPTION	BY	DATE
C	UPDATED VEHICLE DIMS	AB	29/07/2022
D	UPDATED VEHICLE LENGTH	AB	16/08/2022

THIS DRAWING IS CONFIDENTIAL AND IS THE PROPERTY OF GREG ALDERSON AND ASSOCIATES. IT MUST NOT BE DISCLOSED TO A THIRD PARTY, REPRODUCED, COPIED, OR LENT WITHOUT THE WRITTEN CONSENT OF THE PROPRIETOR.

DO NOT SCALE DRAWINGS, USE FIGURED DIMENSIONS

REFER COVER SHEET FOR NOTES UNLESS NOTED OTHERWISE

GREG ALDERSON & ASSOCIATES

ABN 58 594 160 789
43 Main Street CLUNES NSW 2480
Ph: 02 6629 1552

E: office@aldersonassociates.com.au
Web: aldersonassociates.com.au

Client:
VITALE PROPERTY GROUP
PTY LTD

Site address:
29 SHIRLEY STREET
BYRON BAY NSW 2481

Title:
WASTE VEHICLE EXIT
SWEPT PATH DRAWINGS

Project:
29 SHIRLEY STREET
UNIT DEVELOPMENT

FOR INFORMATION

Drawn: AB	Scale: 1:250	Checked:	Date: 16/08/2022
Checked: AE	Original Size: A3		Revision: D
Job Number: 22381	Drawing Number: 22381-CIV-SP-02		