

## LEGEND

12.0	FINISHED SURFACE CONTOURS
	SITE BOUNDARY
	EXISTING PROPERTY BOUNDARY
	EXISTING NOMINAL KERB LINE
	EXISTING EDGE OF BUILDING
	EXISTING EDGE OF BUILDING EAVE
S	EXISTING SEWER
W	EXISTING WATER
OE	EXISTING OVERHEAD ELECTRICITY
X X X X X	ABANDONED SERVICE
	EXISTING BATTER
	EXISTING FENCE
	EXISTING EARTHWORKS DRAIN
	LIMIT OF WORKS
	PROPOSED TURF SWALE TYPE AND SIZE VARIES
SWD	PROPOSED STORMWATER DRAINAGE
SD	PROPOSED SUBSOIL DRAINAGE
S	PROPOSED SEWER
W	PROPOSED WATER MAIN
B1	PROPOSED 'TYPE B1' KERB AND CHANNEL IN ACCORDANCE WITH NORTHERN RIVERS COUNCIL STD DRG R-03.
	PROPOSED ROAD CENTRE LINE
1 2	SEWER STRUCTURE LABEL
	PROPOSED STORMWATER INLET PIT
	PROPOSED STORMWATER MANHOLE
	EXISTING ROAD
	PROPOSED ROAD PAVEMENT
	PROPOSED FOOTPATH IN ACCORDANCE WITH NRC STD DRG R-05.
	PROPOSED DRIVEWAY CROSSOVER IN ACCORDANCE WITH NORTHERN RIVERS COUNCIL STD DRG R-05.
	PROPOSED ROAD PAVEMENT REINSTATEMENT
	PROPOSED 3.0m WIDE SEWER EASEMENT AND EASEMENT FOR DRAINAGE
	PROPOSED 3.0m EASEMENT FOR DRAINAGE
	PROPOSED RETAINING SYSTEM REFER STRUCTURAL DRAWINGS FOR DETAILS
	PROPOSED RETAINING WALL
	PROPOSED EASEMENTS
	EMERGENCY OVERLAND FLOW PATH
	OVERLAND FLOW PATH

## NOTE

REFER DRG DA16 TO DA19 FOR EXTERNAL STORMWATER DRAINAGE DESIGN DETAILS

BYRON SHIRE COUNCIL  
Development Application  
APPROVED PLAN  
DA No. 10.2022.371.1  
Date: 16 October 2023

ALL DETAILS SHOWN ARE  
SUBJECT TO FURTHER  
DETAILED DESIGN

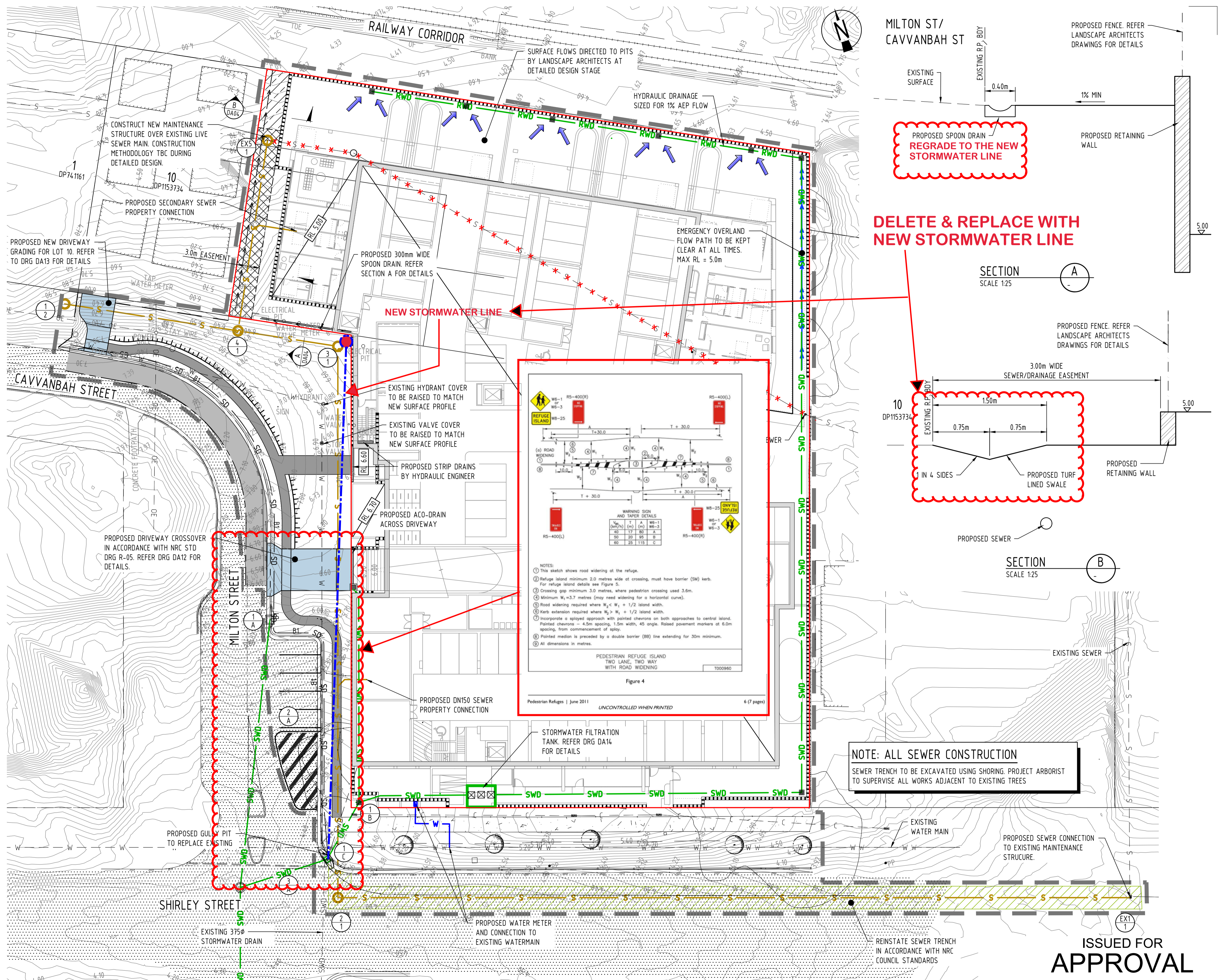

D	11.08.23	ISSUED FOR APPROVAL	MD	ST
C	04.04.23	ISSUED FOR APPROVAL	MD	ST
B	27.03.23	ISSUED FOR APPROVAL	MD	ST
A	10.08.22	ISSUED FOR APPROVAL	MD	ST
03	01.07.22	ISSUED FOR INFORMATION	MD	ST
02	28.06.22	ISSUED FOR INFORMATION	MD	ST
01	27.06.22	ISSUED FOR INFORMATION	MD	ST
Rev	Date	Description	By	Chk

PLOT DATE: 9/11/2023 3:27 PM FILENAME: J:\25000\25799\DA\DWG\25799\_DA04\_PRELIMINARY ENGINEERING SERVICES LAYOUT PLAN.DWG



Gold Coast Office  
Suite 201, Level 1, 1 Short Street,  
Southport, Queensland 4215, Australia  
PO Box 208, Southport BC, Queensland 4215  
T 1300 657 402 F +617 5528 4723  
E info@adgco.com W www.adgco.com  
BRISBANE / DARWIN / GOLD COAST / MELBOURNE / PERTH /  
SUNSHINE COAST / SYDNEY / TOOWOOMBA

Client  
VITALE PROPERTY GROUP PTY LTD

Project Name  
29 SHIRLEY STREET  
BYRON BAY

Discipline  
CIVIL

Designed By  
DE

Project No.  
25799

Status  
APPROVAL

Checked By  
ST

Approved By  
ST

Scale at A1  
1:250

The concepts and information contained in this document are the copyright of ADG Engineers (Aust) Pty Ltd. Use or copying of the document in whole or in part without the written permission of ADG Engineers (Aust) Pty Ltd constitutes an infringement of copyright. Do not scale drawings. If in doubt, ask!

ISSUED FOR  
APPROVAL

Title  
PRELIMINARY ENGINEERING SERVICES  
LAYOUT PLAN

Drawing No.  
DA04

Revision  
D

FULL SIZE ON ORIGINAL 0 10 20 30 40 50 60 70 80 90 100mm

### LEGEND

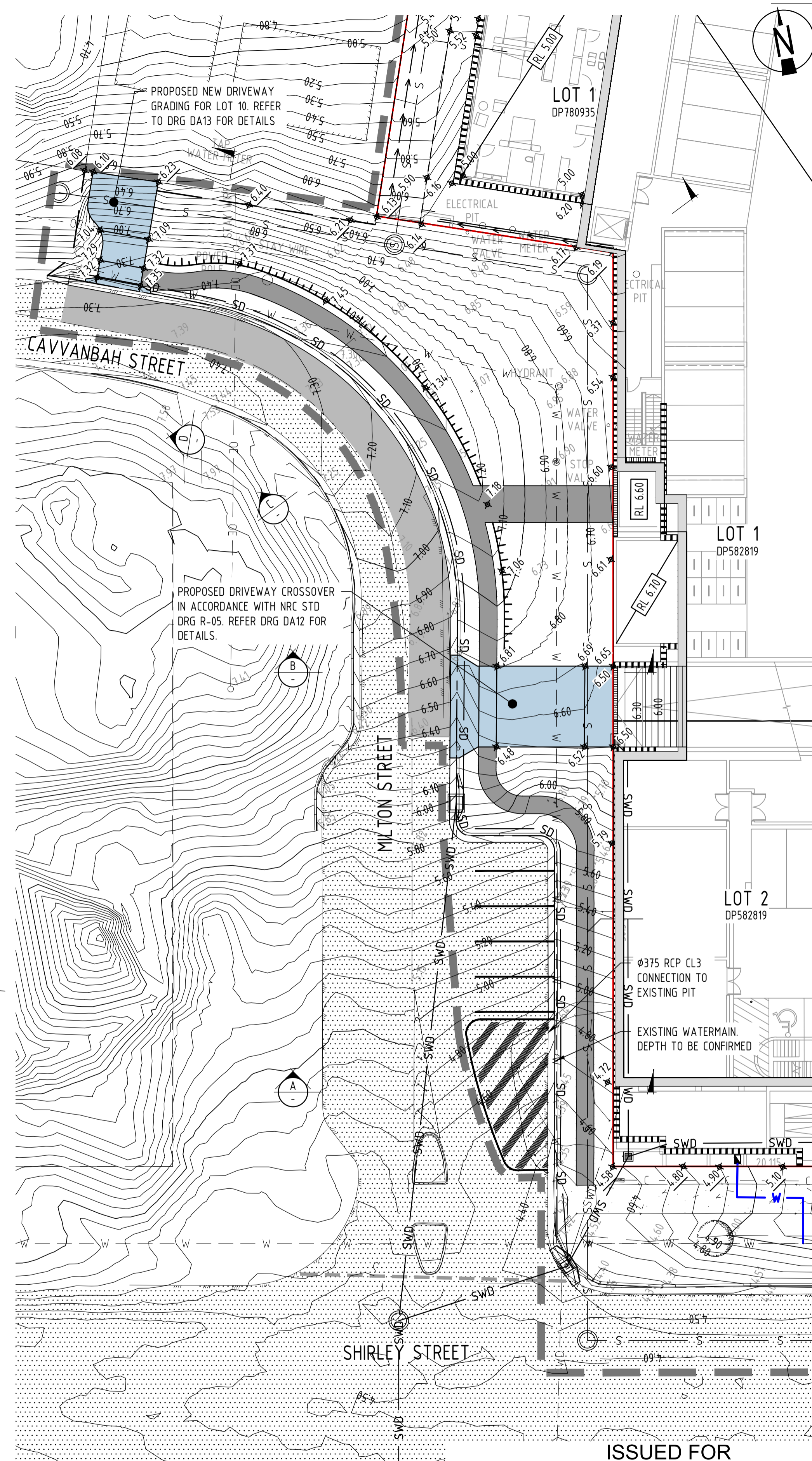
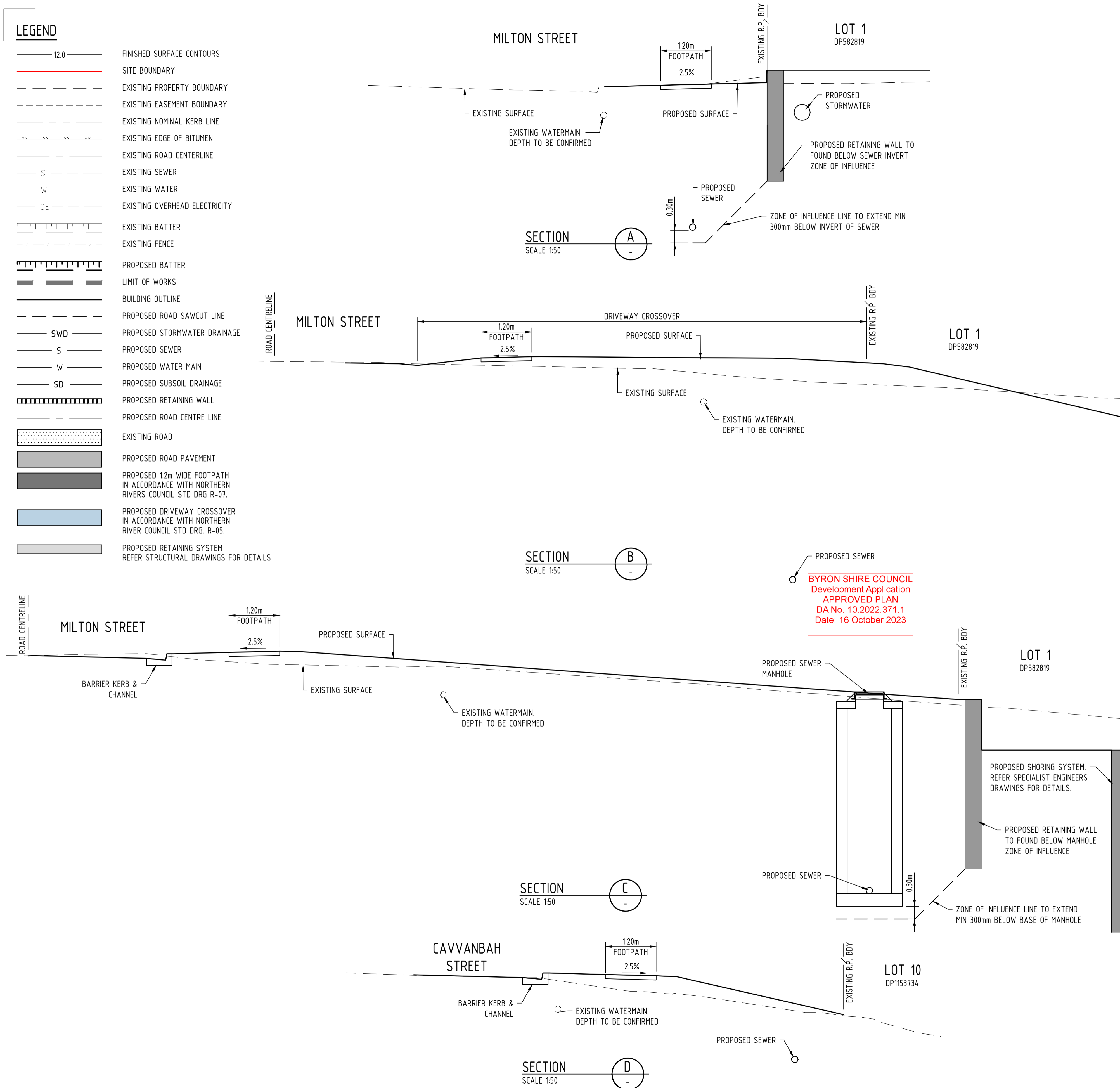
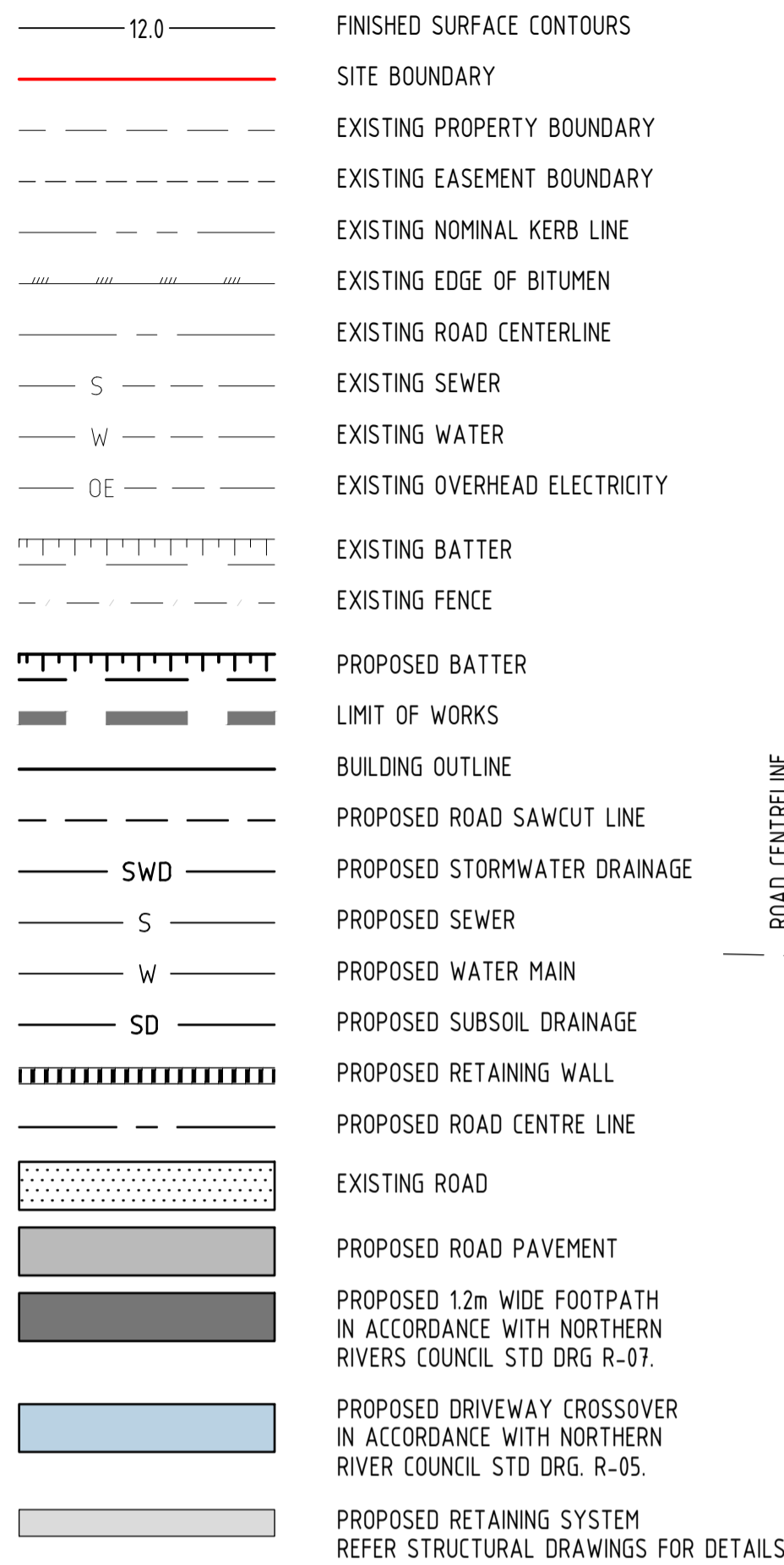

ISSUED FOR  
**APPROVAL**

C	11.08.23	ISSUED FOR APPROVAL		
B	27.03.23	ISSUED FOR APPROVAL	MD	ST
A	10.08.22	ISSUED FOR APPROVAL	MD	ST
03	01.07.22	ISSUED FOR INFORMATION	MD	ST
02	28.06.22	ISSUED FOR INFORMATION	MD	ST
01	27.06.22	ISSUED FOR INFORMATION	MD	ST
Rev	Date	Description	By	Chk

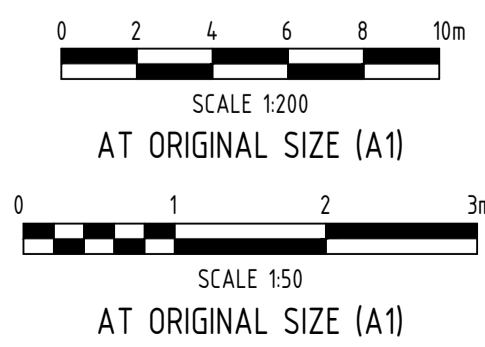

Client	VITALE PROPERTY GROUP PTY LTD
Project Name	29 SHIRLEY STREET BYRON BAY

Discipline CIVIL		Status APPROVAL
Designed By DE	Checked By ST	Approved By ST
Project No. 25799	Drawn By MD	Scale at A1 AS SHOWN

Title  
PRELIMINARY ROAD WIDENING  
LAYOUT PLAN AND SECTIONS  
MILTON STREET

Drawing No.	Revision
DA10	C

LEGEND

	SITE BOUNDARY
	EXISTING PROPERTY BOUNDARY
	EXISTING EASEMENT BOUNDARY
	FINISHED SURFACE CONTOURS
	EXISTING SURFACE LEVEL
	FINISHED SURFACE LEVEL
	EXISTING NOMINAL KERB LINE / EDGE OF ROAD
	EXISTING EDGE OF BITUMEN
	EXISTING WATER
	EXISTING SEWER
	EXISTING OVERHEAD ELECTRICITY
	EXISTING FENCE
	PROPOSED STORMWATER DRAINAGE
	PROPOSED SEWER
	PROPOSED WATER
	PROPOSED SUBSOIL DRAINAGE
	PROPOSED DRIVEWAY CROSSOVER IN ACCORDANCE WITH NORTHERN RIVERS COUNCIL STD DRG. R-05
	PROPOSED FOOTPATH IN ACCORDANCE WITH NORTHERN RIVERS COUNCIL STD DRG. R-07
	PROPOSED ROAD PAVEMENT
	EXISTING ROAD

NOTES

- ALL ROADWORKS AND DRAINAGE CONSTRUCTION AND TESTING TO BE IN ACCORDANCE WITH NORTHERN RIVERS COUNCIL DEVELOPMENT GUIDELINES, DRAWINGS AND SPECIFICATIONS.
- TRENCH BACKFILL UNDER PAVEMENT TO BE COMPACTED TO 100% STANDARD DRY DENSITY (AS1289 5.1.1) IN LAYERS NOT EXCEEDING 150mm OF CBR 15 MATERIAL OR APPROVED EQUIVALENT.
- ALL FOOTPATHS TO BE CONSTRUCTED IN ACCORDANCE WITH NRC DRAWINGS.

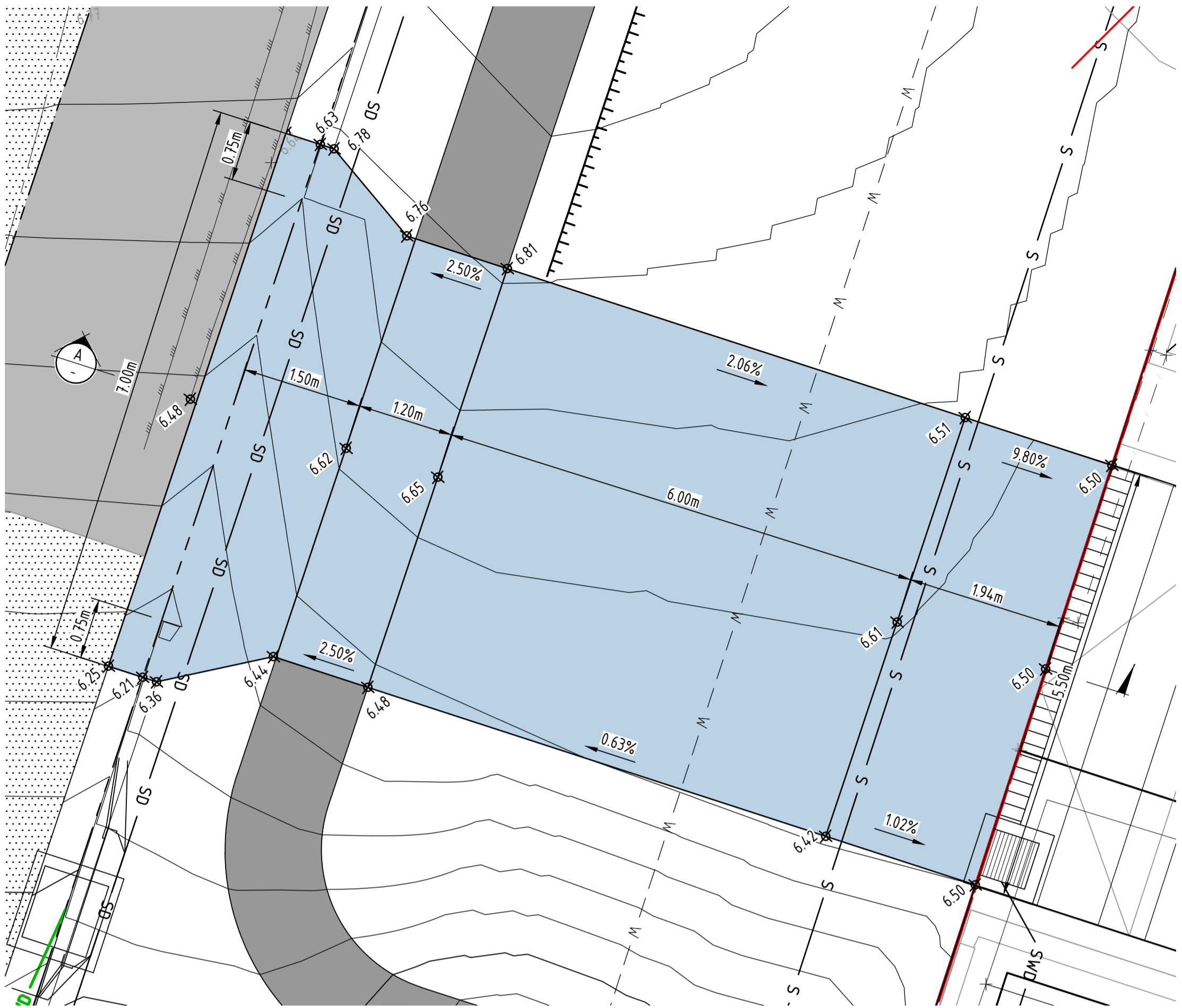

MILTON STREET DRIVEWAY - LAYOUT PLAN  
SCALE 1:50

BYRON SHIRE COUNCIL  
Development Application  
APPROVED PLAN  
DA No. 10.2022.371.1  
Date: 16 October 2023

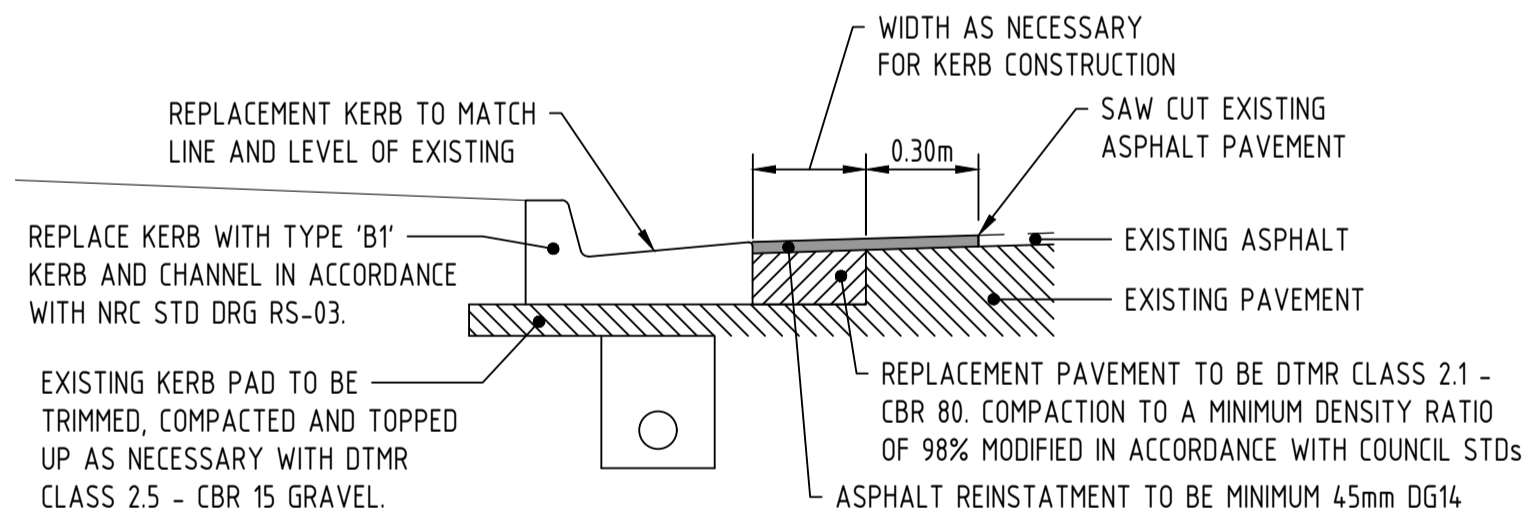

TYPICAL KERB REPLACEMENT DETAIL  
SCALE 1:20

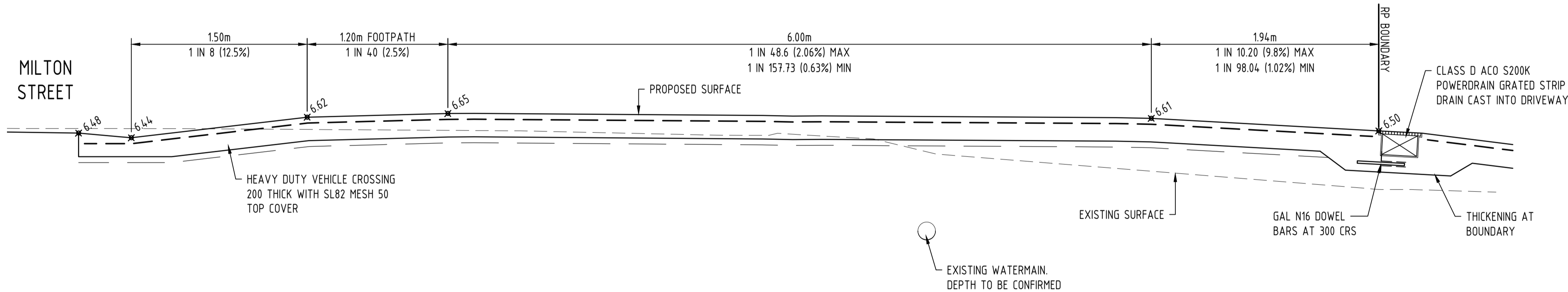

SECTION  
SCALE 1:25

ISSUED FOR  
APPROVAL

Rev	Date	Description	By	Chk
C	11.08.23	ISSUED FOR APPROVAL	MD	ST
B	27.03.23	ISSUED FOR APPROVAL	MD	ST
A	10.08.22	ISSUED FOR APPROVAL	MD	ST
03	01.07.22	ISSUED FOR INFORMATION	MD	ST
02	28.06.22	ISSUED FOR INFORMATION	MD	ST
01	27.06.22	ISSUED FOR INFORMATION	MD	ST

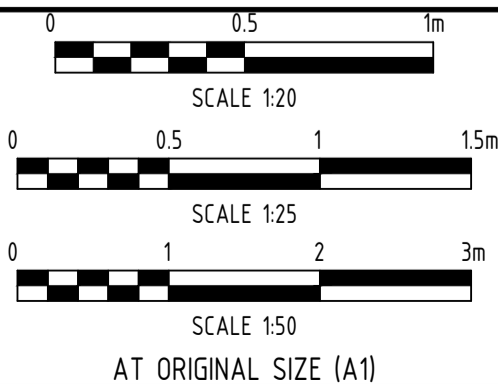

**ADG**  
Gold Coast Office  
Suite 201, Level 1, 1 Short Street,  
Southport, Queensland 4215, Australia  
PO Box 208, Southport BC, Queensland 4215  
T 1300 657 402 F +617 5528 4723  
E info@adgco.com W www.adgco.com  
BRISBANE / DARWIN / GOLD COAST / MELBOURNE / PERTH /  
SUNSHINE COAST / SYDNEY / TOOWOOMBA

Client:  
VITALE PROPERTY GROUP PTY LTD  
Project Name:  
29 SHIRLEY STREET  
BYRON BAY

Discipline:  
CIVIL  
Designed By:  
DE  
Checked By:  
ST  
Project No.:  
25799  
Drawn By:  
MD

Status:  
APPROVAL  
Approved By:  
ST  
Scale at A1:  
AS SHOWN

Title:  
PRELIMINARY DRIVEWAY  
CROSSOVER DETAILS  
MILTON STREET

Drawing No:  
DA12  
Revision:  
C

LEGEND

	SITE BOUNDARY
	EXISTING PROPERTY BOUNDARY
	EXISTING EASEMENT BOUNDARY
	FINISHED SURFACE CONTOURS
	EXISTING SURFACE LEVEL
	FINISHED SURFACE LEVEL
	EXISTING NOMINAL KERB LINE / EDGE OF ROAD
	EXISTING EDGE OF BITUMEN
	EXISTING WATER
	EXISTING SEWER
	EXISTING OVERHEAD ELECTRICITY
	EXISTING FENCE
	PROPOSED STORMWATER DRAINAGE
	PROPOSED SEWER
	PROPOSED WATER
	PROPOSED SUBSOIL DRAINAGE
	PROPOSED DRIVEWAY CROSSOVER IN ACCORDANCE WITH NORTHERN RIVERS COUNCIL STD DRG. R-05
	PROPOSED FOOTPATH IN ACCORDANCE WITH NORTHERN RIVERS COUNCIL STD DRG. R-07
	PROPOSED ROAD PAVEMENT

NOTES

- ALL ROADWORKS AND DRAINAGE CONSTRUCTION AND TESTING TO BE IN ACCORDANCE WITH NORTHERN RIVERS COUNCIL DEVELOPMENT GUIDELINES, DRAWINGS AND SPECIFICATIONS.
- TRENCH BACKFILL UNDER PAVEMENT TO BE COMPACTED TO 100% STANDARD DRY DENSITY (AS1289 5.1.1) IN LAYERS NOT EXCEEDING 150mm OF CBR 15 MATERIAL OR APPROVED EQUIVALENT.
- ALL FOOTPATHS TO BE CONSTRUCTED IN ACCORDANCE WITH NRC DRAWINGS.

BYRON SHIRE COUNCIL  
Development Application  
APPROVED PLAN  
DA No. 10.2022.371.1  
Date: 16 October 2023

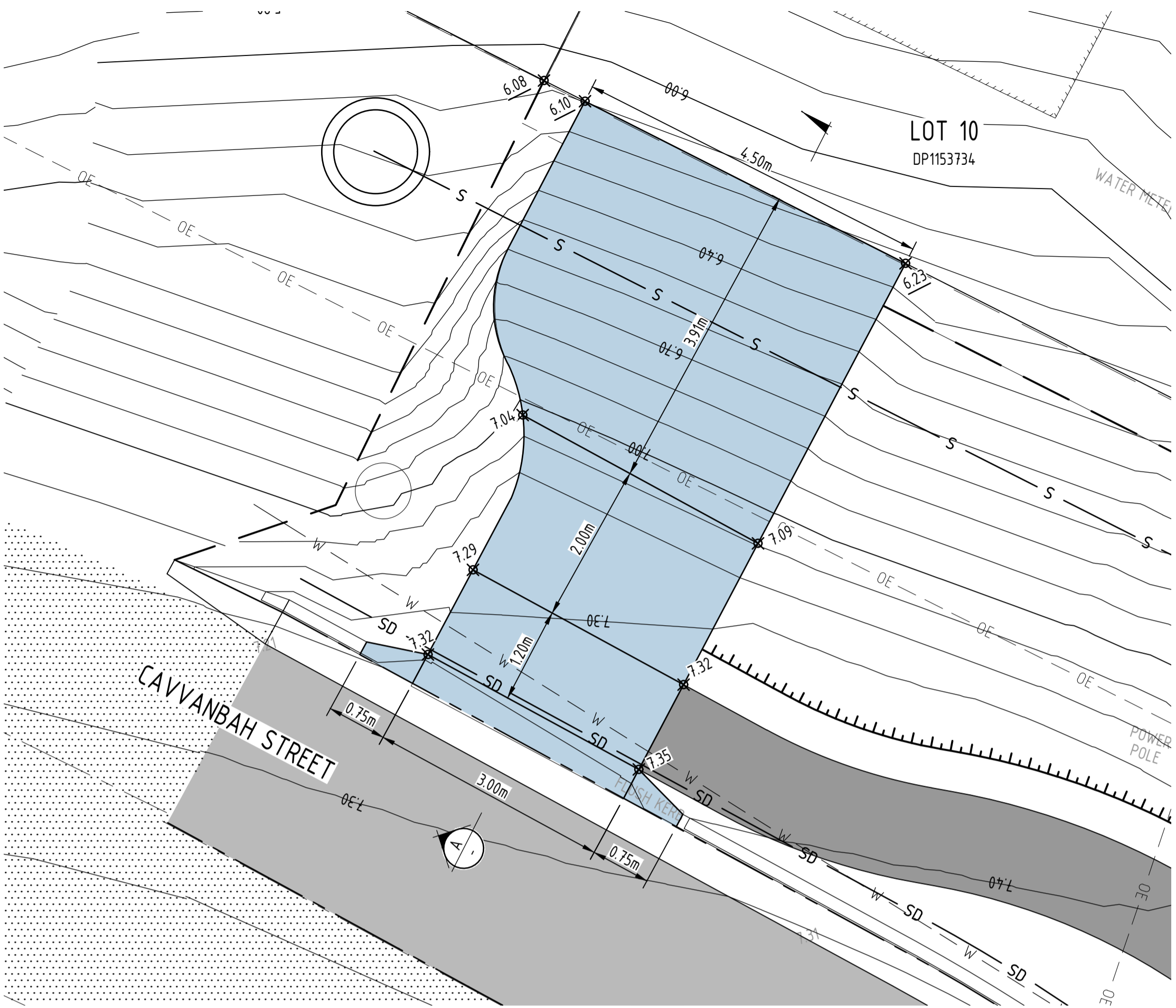

CAVVANBAH STREET DRIVEWAY - LAYOUT PLAN

SCALE 1:50

AMEND GRADING IN ACCORDANCE WITH COUNCIL'S STANDARD DRAWING R06

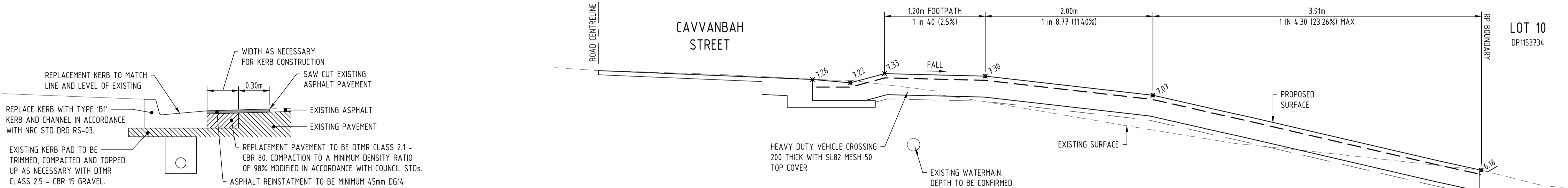

TYPICAL KERB REPLACEMENT DETAIL

SCALE 1:20

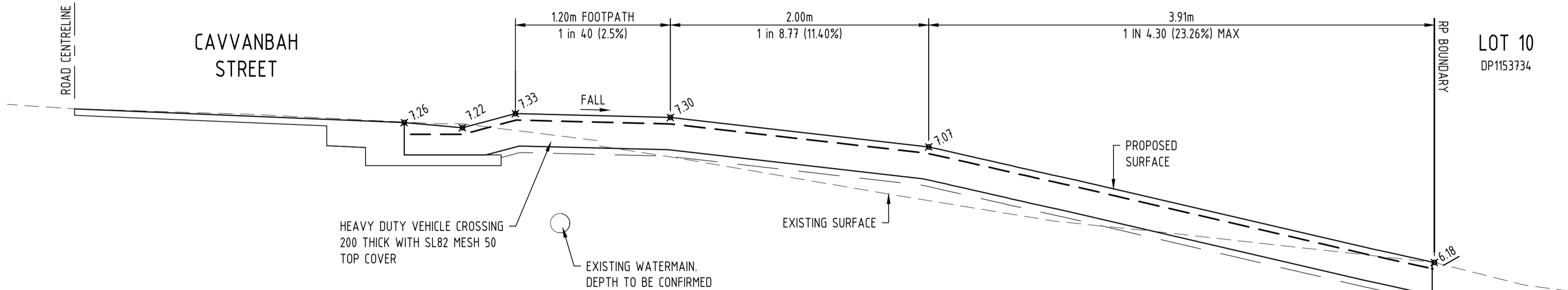

SECTION

SCALE 1:25

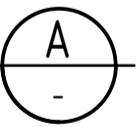

ISSUED FOR  
APPROVAL

C	11.08.23	ISSUED FOR APPROVAL	MD	ST	
B	27.03.23	ISSUED FOR APPROVAL	MD	ST	
A	10.08.22	ISSUED FOR APPROVAL	MD	ST	
Rev	Date	Description	By	Chk	



Client VITALE PROPERTY GROUP PTY LTD	Discipline CIVIL	Status APPROVAL	Title PRELIMINARY DRIVEWAY CROSSOVER DETAILS CAVVANBAH STREET
Project Name 29 SHIRLEY STREET BYRON BAY	Designed By DE	Checked By ST	Approved By ST
	Project No. 25799	Drawn By MD	Scale at A1 AS SHOWN
The concepts and information contained in this document are the copyright of ADG Engineers (Aust) Pty Ltd. Use or copying of the document in whole or in part without the written permission of ADG Engineers (Aust) Pty Ltd constitutes an infringement of copyright. Do not scale drawings. If in doubt, ask!			Drawing No. DA13
			Revision C

