

PLAN OF PORTIONS 159 TO 165
Village of Mullumbimby
Parish of Billinudgel
County of Rous

L. D. MURWILLUMBAH.

Scale of Chains
0 1 2 3 4 5 6 7 8 9 10 11 12

Total Area 21a.2r.23p

Within the Suburban boundaries Village of Mullumbimby
Do Res: 77 from Mining Occupation Not^d 31st July 1888

Within Special N^o 25958 Proclaimed 29th May 1897 Max Area 13.1.9 Min: 2.0.13. Price £4 per ac.
Pors 163, 164, 165. CP 98.10 by Benjamin Carr, Sec 26, May 12th Disallowed 14th June '98

Pors 159, 160, 161, 162 CP 98.9 by Thomas Cranston, Sec 26, May 12th Disallowed 14th June '98

Pors 163, 164, 165 CP 98.16 by John Crawford Mansell, Sec 26, Aug 25th Confirmed 10th Oct. 98 vide L.B. 98.5078.

Pors 159, 160, 161, 162 CP 99.1 by Wm Rose Sec 26 Jan 5th Confirmed 27th May '99 vide L.B. 99.2492

Within the Tawonga and Koonunga
Rivers Gold Field Proclaimed
22nd October 1887. Open to
Conditional Purchase

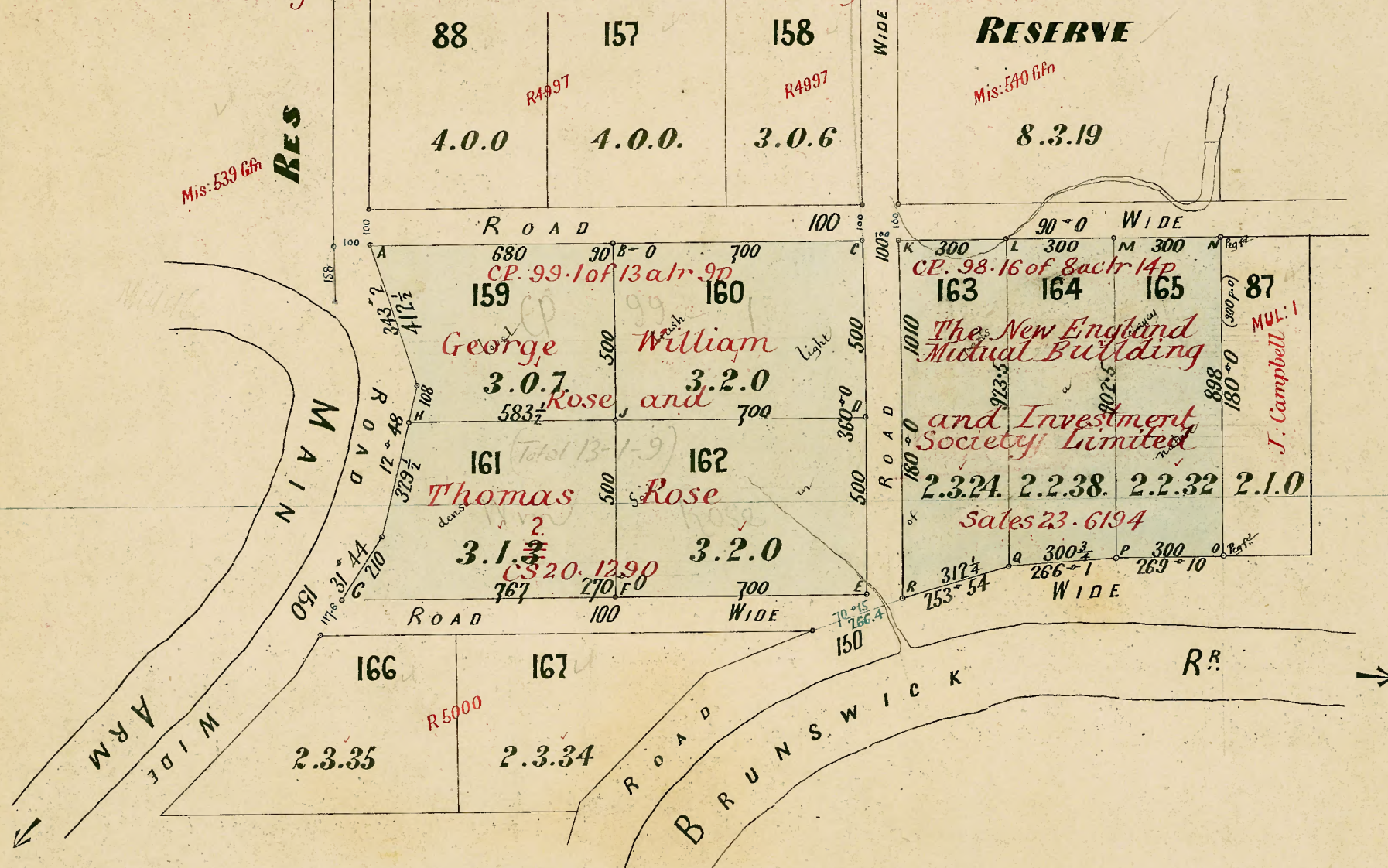

PLAN MICROFILMED
NO ADDITIONS OR AMENDMENTS TO BE MADE

REFERENCE TO CORNERS

CR	BEARING	FROM	LINKS	N ^o ON TREE
A	23° 10'	Brush	15.4	159
B	39° 15'	Brush	32.5	159 . 160
C	150° 20'	Brush	3.5	160
D	66° 10'	Brush	11.5	160 . 162
E	33° 50'	Brush	8.6	162
F	335° 10'	Brush	13	161 x 162
G	189° 5'	Brush	44	161
H	23° 0'	Brush	20.5	159 x 161
J	307° 50'	Brush	4.3	159, 160, 161, 162
K	170° 15'	Beam	25	163
L	148° 30'	Brush	39.5	163 . 164
M	107° 20'	Brush	41	164 . 165
N	126° 10'	Brush	115	87 . 165 (new)
O	256° 30'	Brush	20	87 . 165
P	101° 40'	Brush	32.6	164 . 165
Q	147° 0'	Brush	10.5	163 . 164
R	5° 30'	Water Gum	5	163

Field Book Vol. 5321 Folio 30 & 32

Azimuth taken from Observation. Variation 8° 59' East

20-5-97

Certified True and Correct
20-6-97

4999-1759 R4999.1759

I hereby certify that I in person made & on the 15th Oct '96 completed the survey represented on this plan on which are written the lengths & bearings of the lines measured by me & I declare the lines have been executed in accordance with the Regulations published for the guidance of Licensed Surveyors & the practice of the Department of Lands

L. D. Murwillumbah

Lie: Surveyor.

Transmitted to the District Surveyor with my letter of 22 Oct 96/25

Voucher N^o 96-24 Passed £14.12.9 R. B. Robinson 26 Feb 1897
Calculation Book N^o 1678 folios 58 & 59
Checked and Charted 26th February 1897 A. B. Howell
Examined 27 February 1897 R. B. Robinson
Plan approved 2nd March 1897 R. B. Robinson
District Surveyor



Provided by CITEC Confirm

NEW SOUTH WALES LAND REGISTRY SERVICES - TITLE SEARCH

FOLIO: 159/755687

SEARCH DATE	TIME	EDITION NO	DATE
13/3/2024	11:31 PM	1	13/9/2022

LAND

LOT 159 IN DEPOSITED PLAN 755687
AT MULLUMBIMBY
LOCAL GOVERNMENT AREA BYRON
PARISH OF BILLINUDGEL COUNTY OF ROUS
(FORMERLY KNOWN AS PORTION 159)
TITLE DIAGRAM CROWN PLAN 4999.1759

FIRST SCHEDULE

KENNETH CECIL RYAN
IN 1/2 SHARE
WILLIAM JOHN RYAN
IN 1/2 SHARE
AS TENANTS IN COMMON (AD AS467239)

SECOND SCHEDULE (1 NOTIFICATION)

1 LAND EXCLUDES MINERALS AND IS SUBJECT TO RESERVATIONS AND
CONDITIONS IN FAVOUR OF THE CROWN - SEE CROWN GRANT(S)

NOTATIONS

UNREGISTERED DEALINGS: NIL

*** END OF SEARCH ***

24011

PRINTED ON 13/3/2024

Provided on 13/03/2024 10:31 PM by CITEC Confirm

* Any entries preceded by an asterisk do not appear on the current edition of the Certificate of Title. Warning: the information appearing under notations has not been formally recorded in the Register.

CITEC Confirm hereby certifies that the information contained in this document has been provided electronically by the Registrar General in accordance with section 96B(2) of the Real Property Act, 1900.

Information contained in this document is provided by CITEC Confirm, ABN 52 566 829 700, confirm.com.au, an approved NSW Land Registry Services Information Broker.

© Office of the Registrar General 2024.