

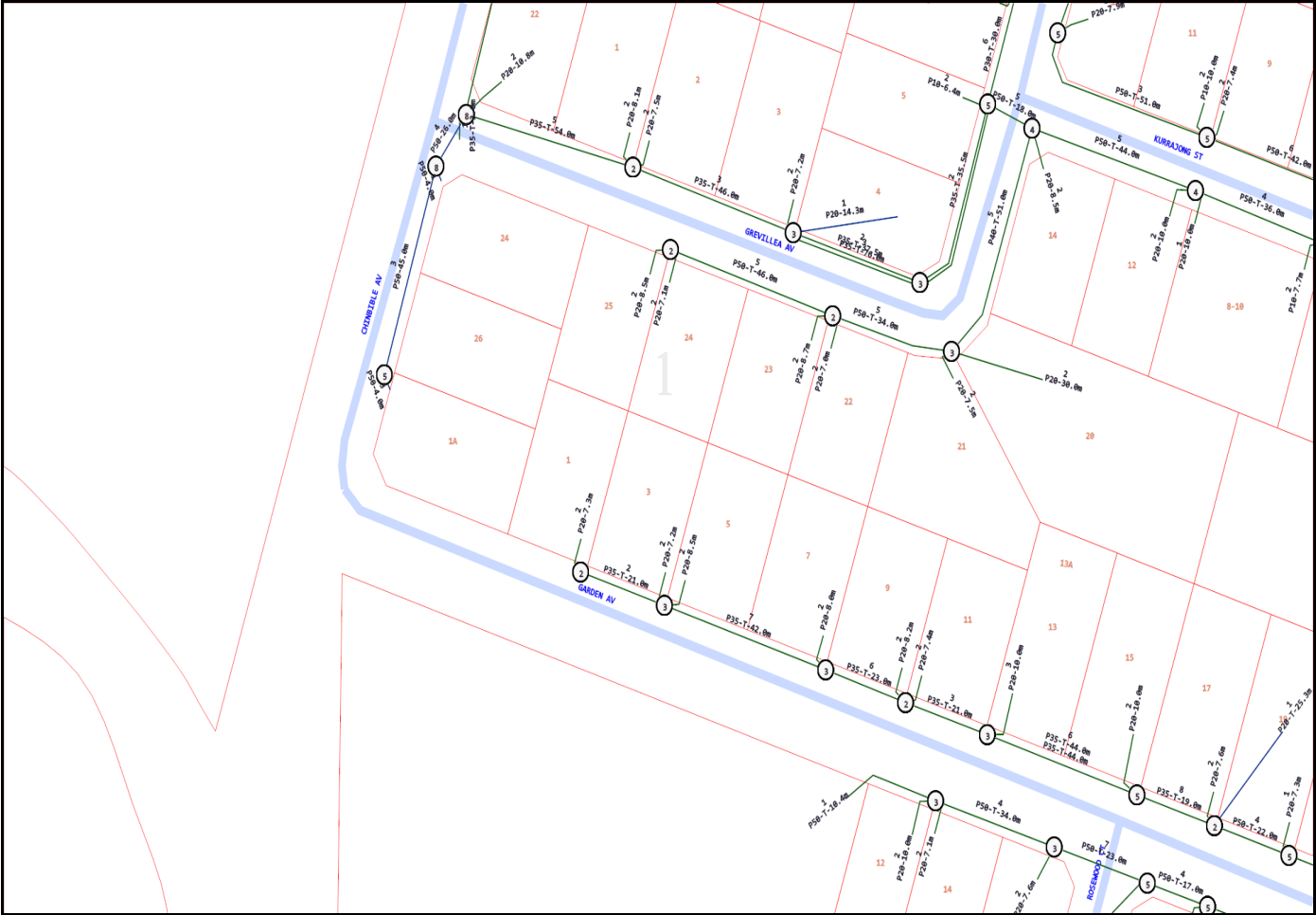

LEGEND



	Parcel and the location
	Pit with size "5"
	Power Pit with size "2E". Valid PIT Size: e.g. 2E, 5E, 6E, 8E, 9E, E, null.
	Manhole
	Pillar
	Cable count of trench is 2. One "Other size" PVC conduit (PO) owned by Telstra (-T-), between pits of sizes, "5" and "9" are 25.0m apart. One 40mm PVC conduit (P40) owned by NBN, between pits of sizes, "5" and "9" are 20.0m apart.
	2 Direct buried cables between pits of sizes, "5" and "9" are 10.0m apart.
	Trench containing any INSERVICE/CONSTRUCTED (Copper/RF/Fibre) cables.
	Trench containing only DESIGNED/PLANNED (Copper/RF/Fibre/Power) cables.
	Trench containing any INSERVICE/CONSTRUCTED (Power) cables.
	Road and the street name "Broadway ST"
Scale	0 20 40 60 Meters 1:2000 1 cm equals 20 m



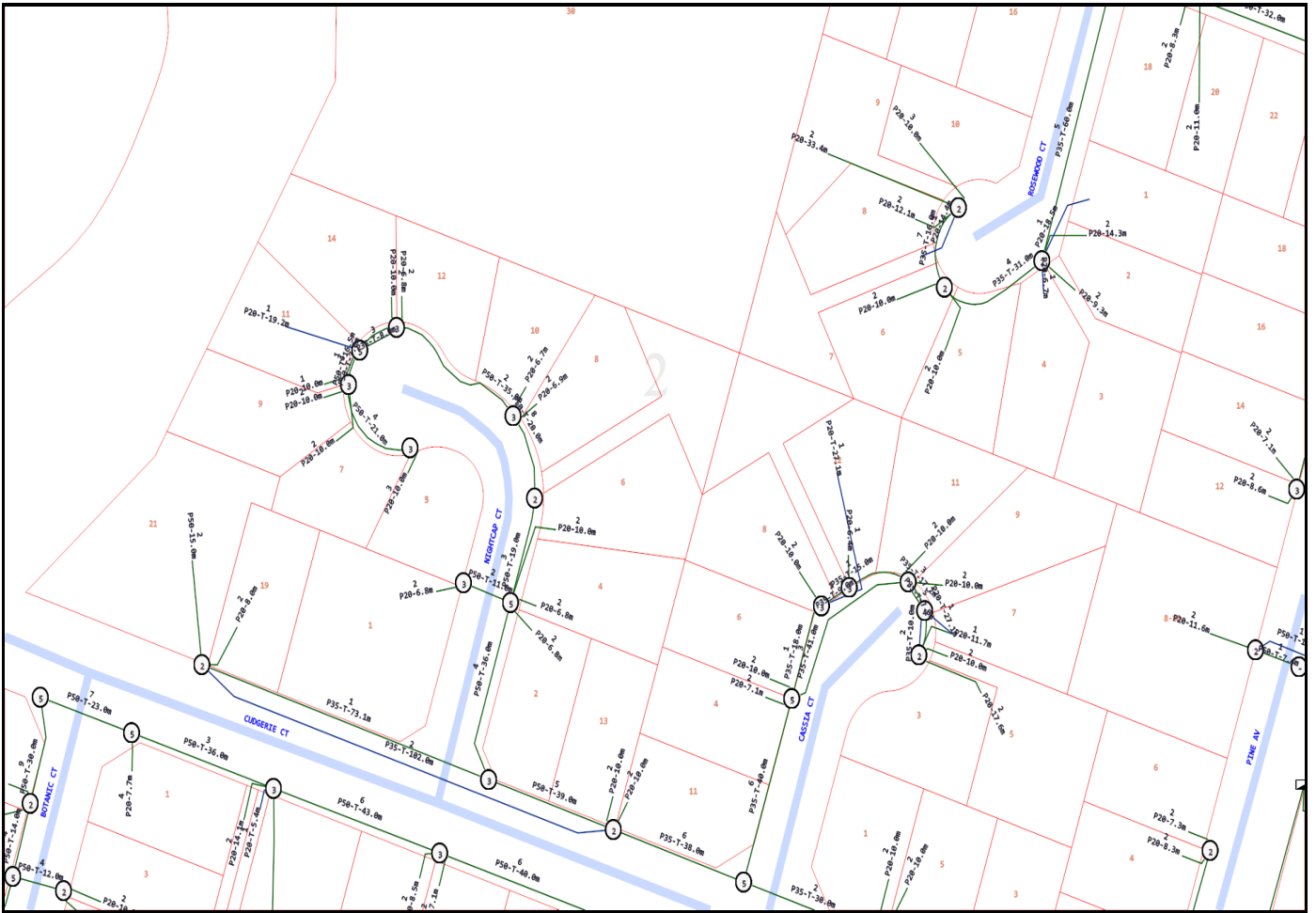

Emergency Contacts

You must immediately report any damage to the **nbn™** network that you are/become aware of. Notification may be by telephone - 1800 626 329.

Legend

- Water Main Drinking
- - - Water Main Abandoned
- Water Meter Pipe
- ▲ Water Valves
- Water Hydrants
- Water Main Recycled
- ▲ Water Valves Recycled
- Wastewater Gravity Main
- - - Wastewater Abandoned
- Wastewater Manhole
- Wastewater Rising Main
- ▲ Wastewater Valve
- Wastewater Vacuum Main
- ▲ Wastewater Vacuum Valves
- Wastewater Vacuum Pods
- Wastewater Pressure Main
- ▲ Wastewater Pressure Valve
- Stormwater Main
- - - Stormwater Abandoned
- Stormwater Pit
- Stormwater Culvert
- SCIMS Survey Control Point
- Incomplete Data
- Property Boundary
- Road Reserve
- Rivers
- Contamination No Digging



Scale: 1:2050
Expires: 03 Jan 2024

DISCLAIMER: While reasonable measures have been taken to ensure the accuracy of the information contained in this plan response, neither Byron Shire Council nor PelicanCorp shall have any liability whatsoever in relation to any loss, damage, cost or expense arising from the use of this plan response or the information contained in it or the completeness or accuracy of such information. Use of such information is subject to and constitutes acceptance of these terms.

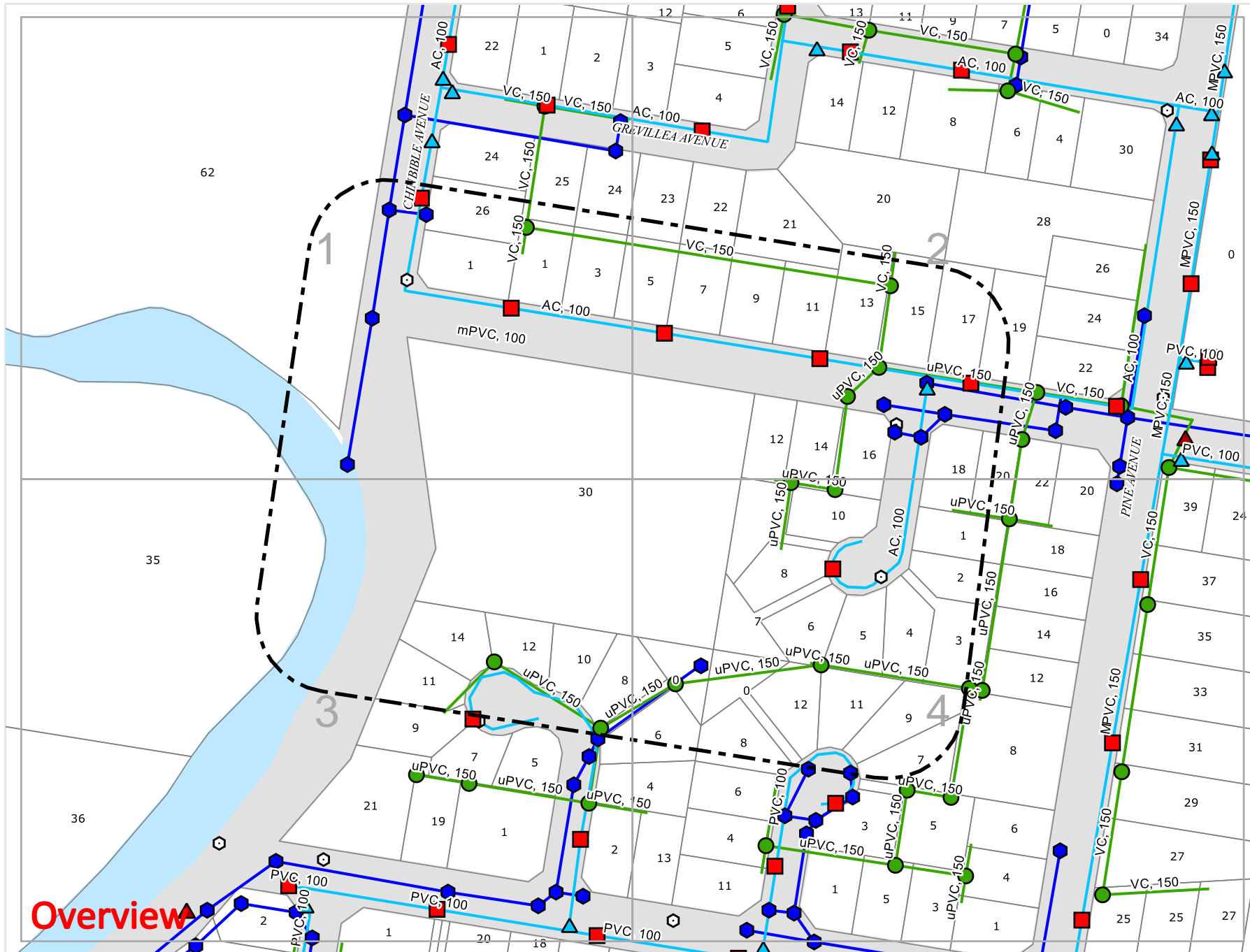



Sequence No: 233038207
Job No: 35623195
Location: 30 Chinbible Avenue, Mullumbimby, NSW 2482



Legend

- Water Main Drinking
- Water Main Abandoned
- Water Meter Pipe
- Water Valves
- Water Hydrants
- Water Main Recycled
- Water Valves Recycled
- Wastewater Gravity Main
- Wastewater Abandoned
- Wastewater Manhole
- Wastewater Rising Main
- Wastewater Valve
- Wastewater Vacuum Main
- Wastewater Vacuum Valves
- Wastewater Vacuum Pods
- Wastewater Pressure Main
- Wastewater Pressure Valve
- Stormwater Main
- Stormwater Abandoned
- Stormwater Pit
- Stormwater Culvert
- SCIMS Survey Control Point
- Incomplete Data
- Property Boundary
- Road Reserve
- Rivers
- Contamination No Digging



Scale: 1:1000
Expires: 03 Jan 2024

DISCLAIMER: While reasonable measures have been taken to ensure the accuracy of the information contained in this plan response, neither Byron Shire Council nor PelicanCorp shall have any liability whatsoever in relation to any loss, damage, cost or expense arising from the use of this plan response or the information contained in it or the completeness or accuracy of such information. Use of such information is subject to and constitutes acceptance of these terms.

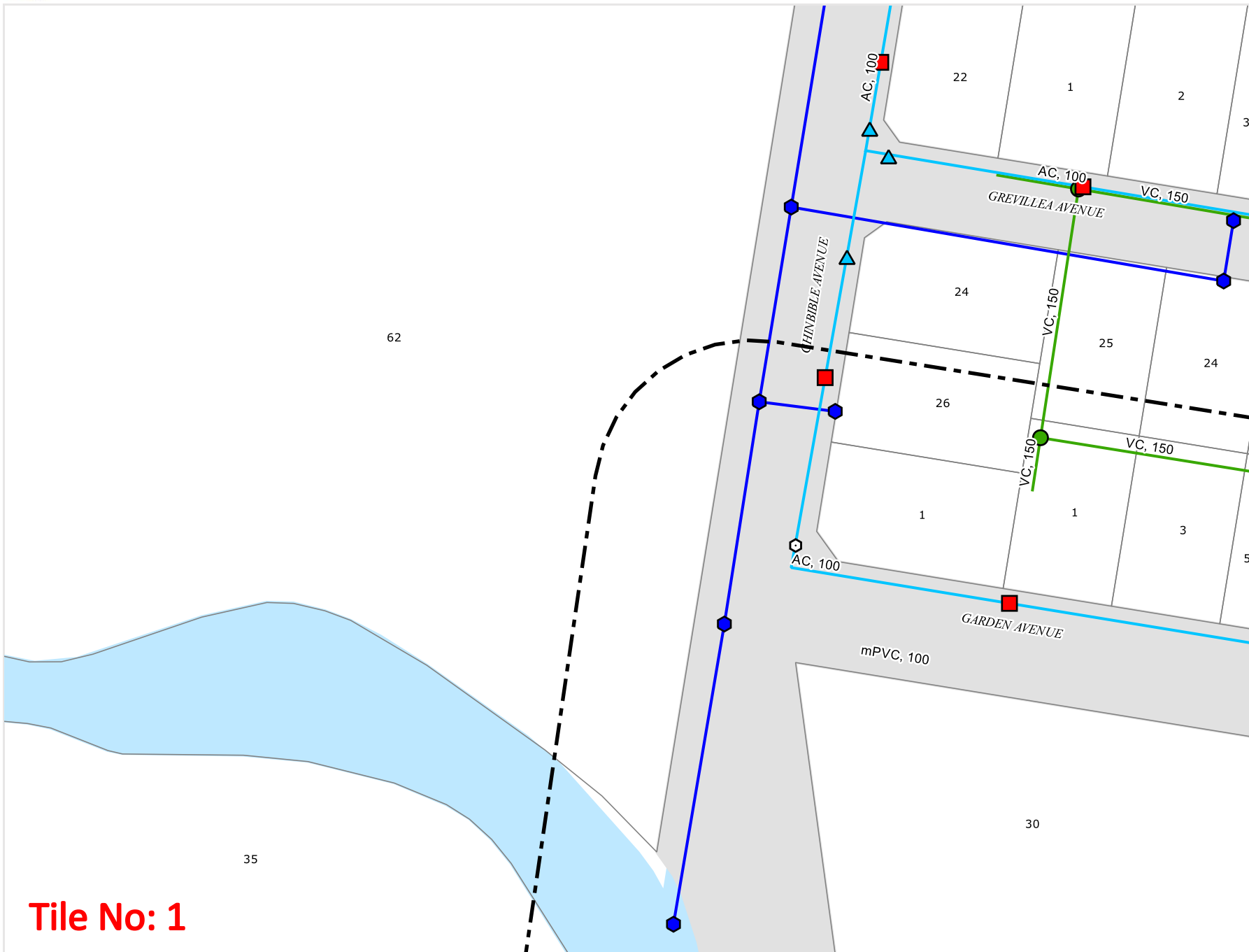

Tile No: 1



Sequence No: 233038207
Job No: 35623195
Location: 30 Chinbible Avenue, Mullumbimby, NSW 2482



Legend

- Water Main Drinking
- Water Main Abandoned
- Water Meter Pipe
- Water Valves
- Water Hydrants
- Water Main Recycled
- Water Valves Recycled
- Wastewater Gravity Main
- Wastewater Abandoned
- Wastewater Manhole
- Wastewater Rising Main
- Wastewater Valve
- Wastewater Vacuum Main
- Wastewater Vacuum Valves
- Wastewater Vacuum Pods
- Wastewater Pressure Main
- Wastewater Pressure Valve
- Stormwater Main
- Stormwater Abandoned
- Stormwater Pit
- Stormwater Culvert
- SCIMS Survey Control Point
- Incomplete Data
- Property Boundary
- Road Reserve
- Rivers
- Contamination No Digging



Scale: 1:1000
Expires: 03 Jan 2024

DISCLAIMER: While reasonable measures have been taken to ensure the accuracy of the information contained in this plan response, neither Byron Shire Council nor PelicanCorp shall have any liability whatsoever in relation to any loss, damage, cost or expense arising from the use of this plan response or the information contained in it or the completeness or accuracy of such information. Use of such information is subject to and constitutes acceptance of these terms.

Tile No: 2



Sequence No: 233038207
Job No: 35623195
Location: 30 Chinbible Avenue, Mullumbimby, NSW 2482



Legend

- Water Main Drinking
- Water Main Abandoned
- Water Meter Pipe
- Water Valves
- Water Hydrants
- Water Main Recycled
- Water Valves Recycled
- Wastewater Gravity Main
- Wastewater Abandoned
- Wastewater Manhole
- Wastewater Rising Main
- Wastewater Valve
- Wastewater Vacuum Main
- Wastewater Vacuum Valves
- Wastewater Vacuum Pods
- Wastewater Pressure Main
- Wastewater Pressure Valve
- Stormwater Main
- Stormwater Abandoned
- Stormwater Pit
- Stormwater Culvert
- SCIMS Survey Control Point
- Incomplete Data
- Property Boundary
- Road Reserve
- Rivers
- Contamination No Digging



Scale: 1:1000
Expires: 03 Jan 2024

DISCLAIMER: While reasonable measures have been taken to ensure the accuracy of the information contained in this plan response, neither Byron Shire Council nor PelicanCorp shall have any liability whatsoever in relation to any loss, damage, cost or expense arising from the use of this plan response or the information contained in it or the completeness or accuracy of such information. Use of such information is subject to and constitutes acceptance of these terms.

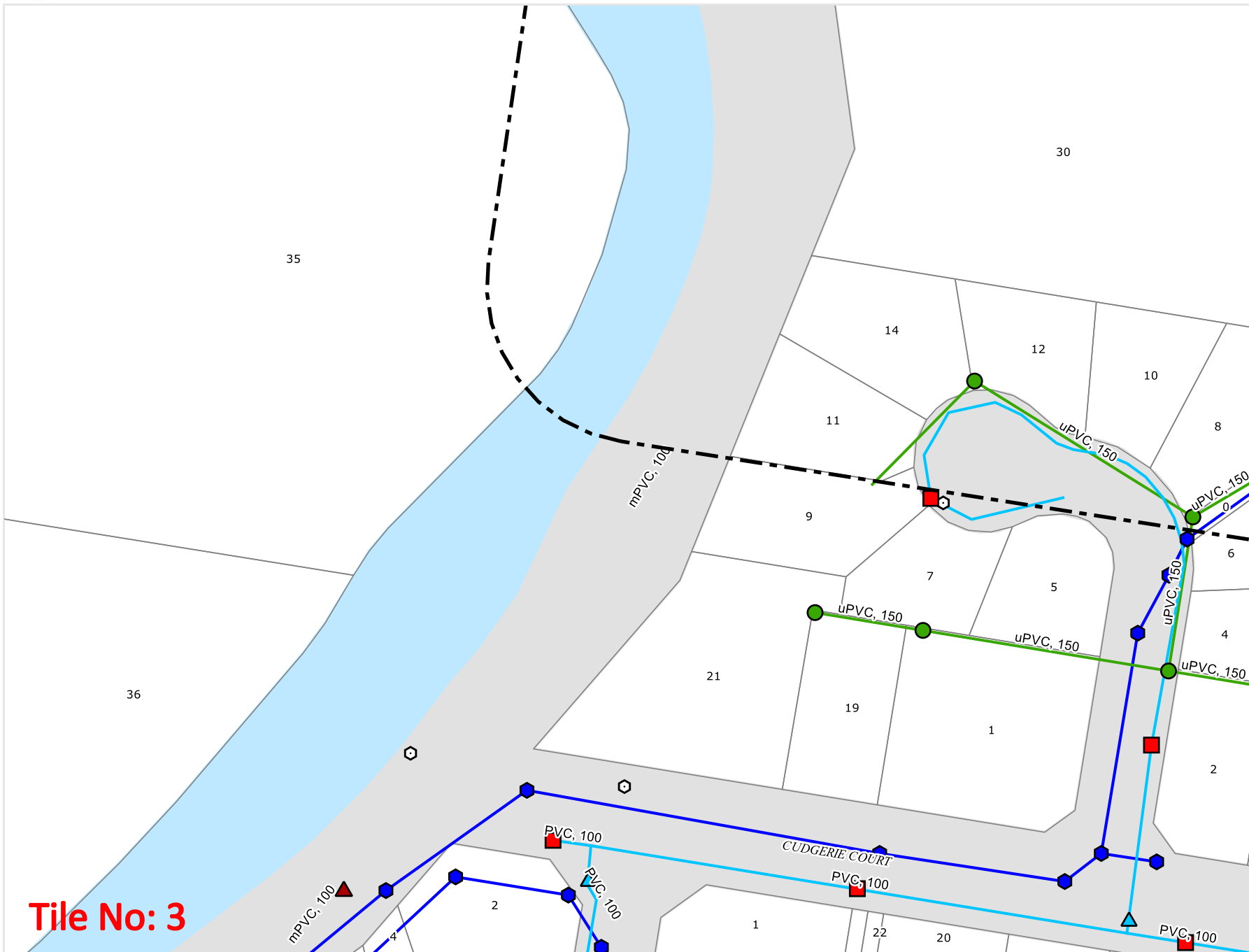

Tile No: 3



Sequence No: 233038207
Job No: 35623195
Location: 30 Chinbible Avenue, Mullumbimby, NSW 2482



Legend

- Water Main Drinking
- Water Main Abandoned
- Water Meter Pipe
- Water Valves
- Water Hydrants
- Water Main Recycled
- Water Valves Recycled
- Wastewater Gravity Main
- Wastewater Abandoned
- Wastewater Manhole
- Wastewater Rising Main
- Wastewater Valve
- Wastewater Vacuum Main
- Wastewater Vacuum Valves
- Wastewater Vacuum Pods
- Wastewater Pressure Main
- Wastewater Pressure Valve
- Stormwater Main
- Stormwater Abandoned
- Stormwater Pit
- Stormwater Culvert
- SCIMS Survey Control Point
- Incomplete Data
- Property Boundary
- Road Reserve
- Rivers
- Contamination No Digging



Scale: 1:1000
Expires: 03 Jan 2024

DISCLAIMER: While reasonable measures have been taken to ensure the accuracy of the information contained in this plan response, neither Byron Shire Council nor PelicanCorp shall have any liability whatsoever in relation to any loss, damage, cost or expense arising from the use of this plan response or the information contained in it or the completeness or accuracy of such information. Use of such information is subject to and constitutes acceptance of these terms.

Tile No: 4

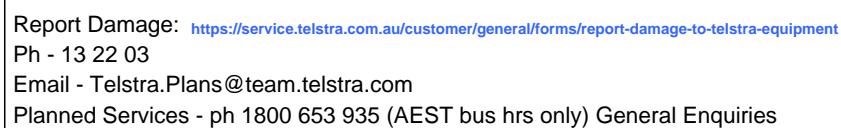

Generated On 06/12/2023 14:02:58

Please read Duty of Care prior to any excavating

Page 1 of 1

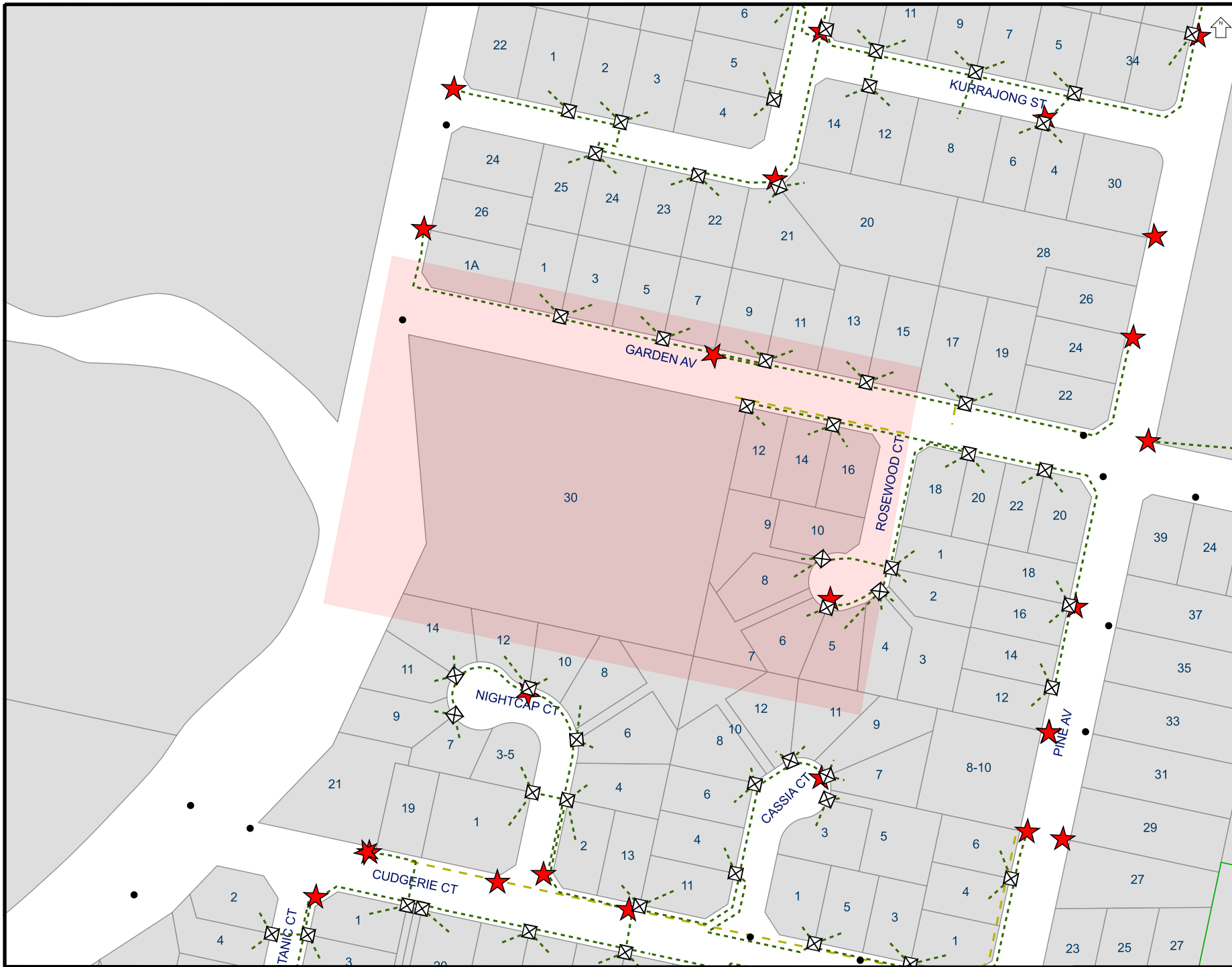

Overhead wires not shown
LOOK UP & LIVE!

LEGEND

- LV Underground Cable
- HV Underground Cable
- Underground Pipe
- ★ Underground Earth or Wires
- ▲ Ground Substation
- Pole
- ✕ Cubicle
- Pit
- Area of Interest

Critical Assets

Contact Essential Energy
on 13 23 91

- ▨ Zone Substation
- Underground Cable
- Underground Fibre

Proposed Works

- ▨ Area of proposed works

Proposed assets are shown as
orange symbols

**THE INFORMATION ON THIS
MAP MAY NOT BE
ACCURATE.**

If details are
incorrect, please
notify

Essential Energy on
13 23 91
(or fax 1800 354 636)

ISSUE DATE: 06/12/2023

You must resubmit your
request if you have not
started work within 4 weeks
of the 'Issue Date' above

A4 SCALE: 1:2017



Job Number: 35623195

Sequence number: 233038208

Job location: 30 Chinbible Avenue, Mullumbimby

Map
Centre: 153° 29' 22.8", -28° 33' 1.5"