

PROPOSED DEVELOPMENT
INGROUND SWIMMING POOL
TO
AN EXISTING
SINGLE STOREY RESIDENCE
&
DETACHED GARAGE

MR TODD & MRS SARAH MOSELEY
210 MAIN ARM ROAD
MULLUMBIMBY NSW 2482
LOT 9
DP 606129

PLAN NO. 2988B
11th July, 2024.

PARAMETER DESIGNS

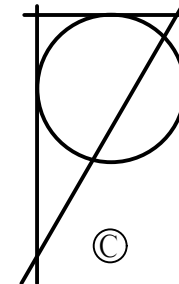

SONIA MACOURT
11 Poplar Avenue
CABARITA BEACH NSW 2488
MOBILE: 0438 647 942
sonia@parameterdesigns.com

210 MAIN ARM ROAD
MULLUMBIMBY NSW 2482
LOT 9
DP 606129
AREA: 4001.00m²
ZONE: RU1 – PRIMARY PRODUCTIO
HEIGHT: J–9.0m
FSR: N/A
ACID SULFATE: N/A
FLOOD: N/A
ABORIGINAL: N/A
BUSHFIRE: VEGETATION CATEGORY 1 & VEGETATION BUFFER

SITE COVER CALCULATIONS

DESCRIPTION	AREA (m ²)
RESIDENCE	190.00
GARAGE	50.55
SHEDS	60.88
TOTAL SITE COVER AREA	301.43
TOTAL SITE AREA	4001.00

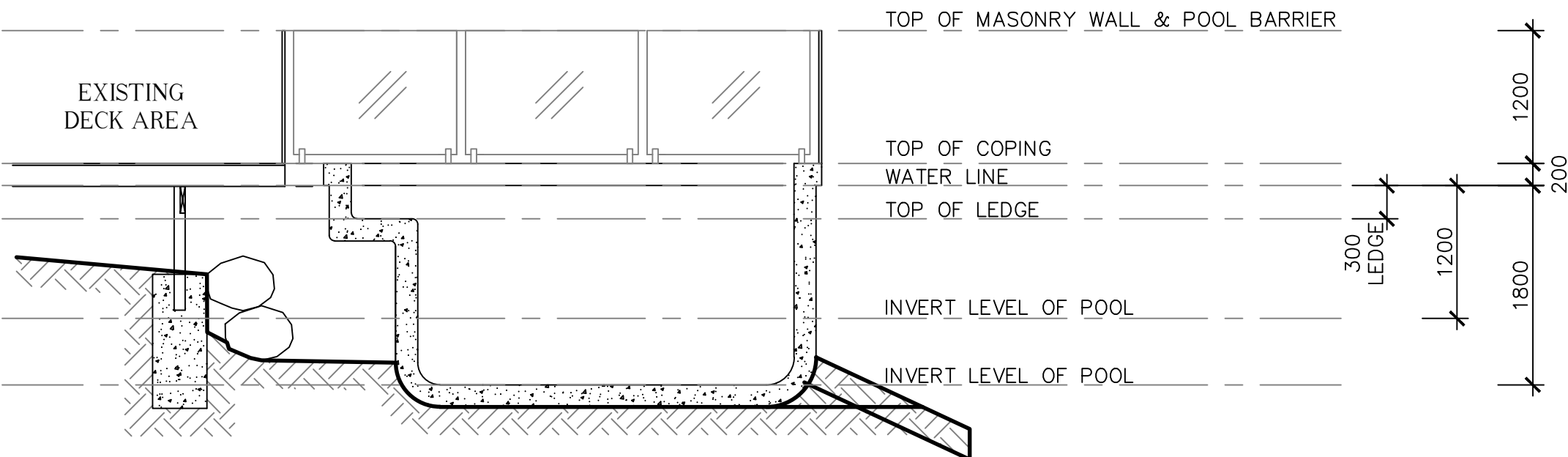
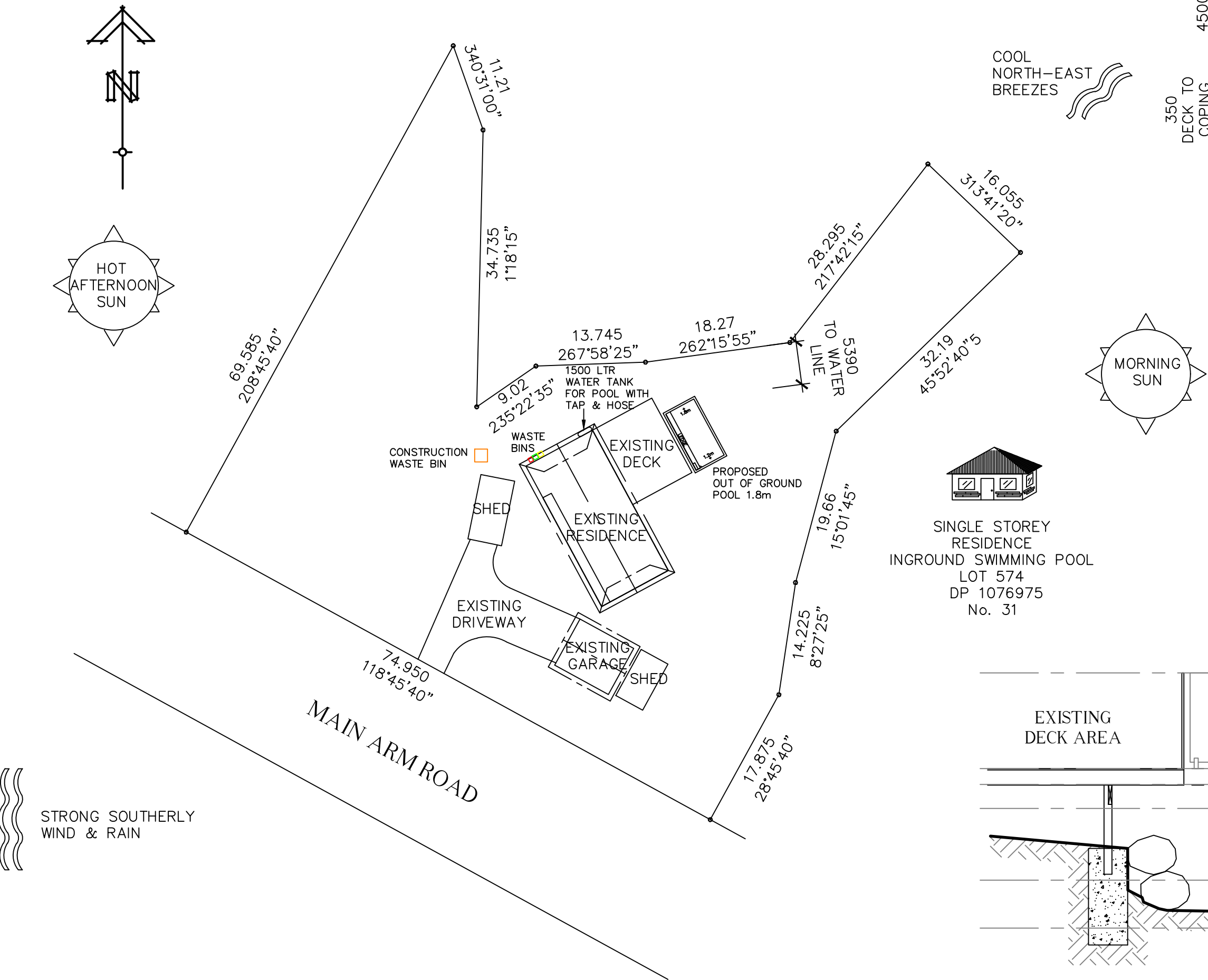
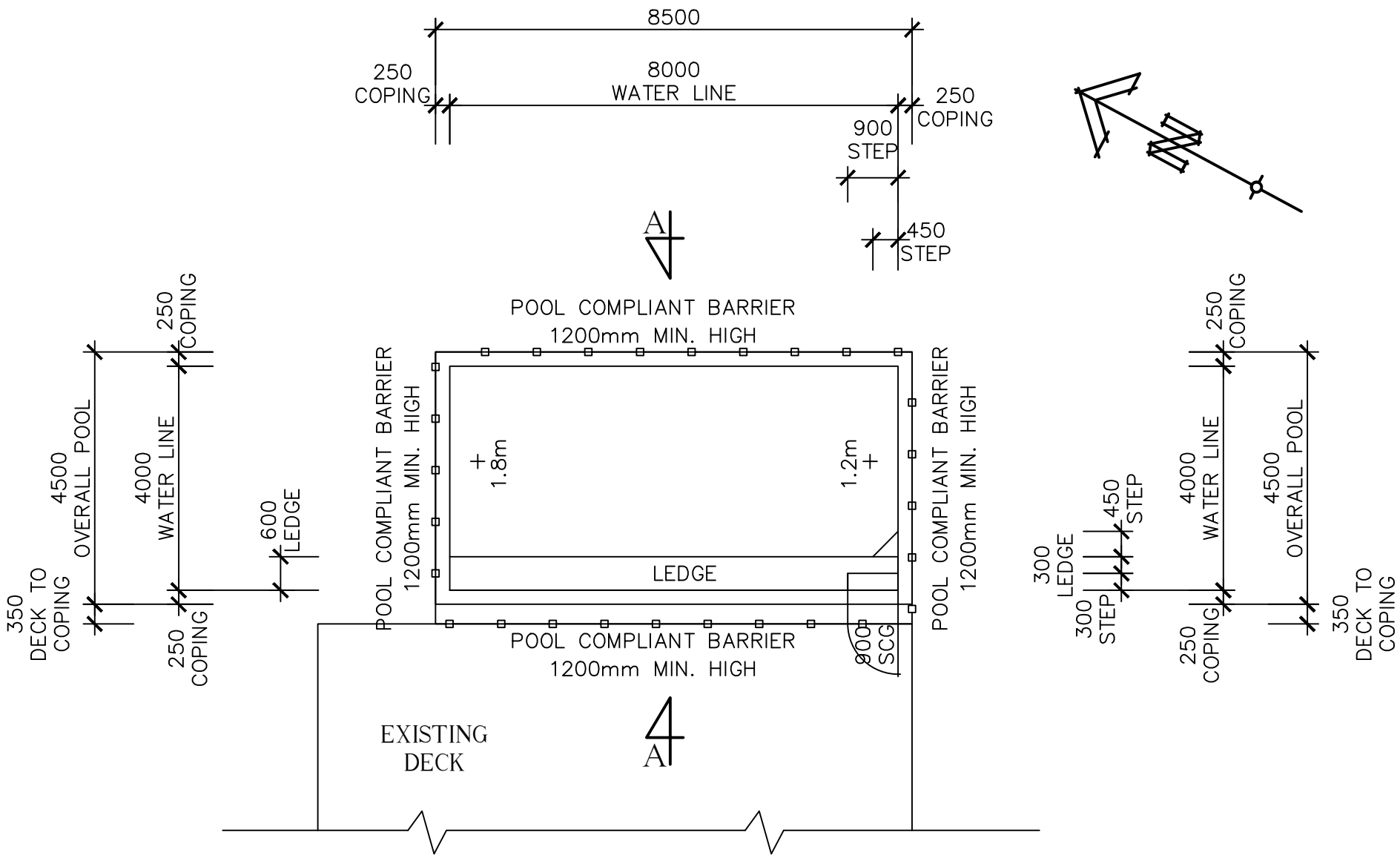

NOTE:
ALL DIMENSIONS SHOWN TAKE PRECEDENCE
OVER SCALE. DO NOT SCALE DRAWING.
ALL DIMENSION TO BE CHECKED
BY BUILDER PRIOR TO COMMENCEMENT
OF WORK. ALL BUILDING WORK TO BE IN
ACCORDANCE WITH THE BUILDING CODE
OF AUSTRALIA AND RELEVANT
AUSTRALIAN STANDARDS AND COUNCIL

PROPOSED DEVELOPMENT

IN-GROUND SWIMMING POOL: 38.25m²
POOL VOLUME: 57.380kLs

DATE: 12th July, 2024
PLAN NO. 2988B
SHEET NO. SHEET 1 OF 1
SCALE: 1:500, 1:100, 1:50

CLIENT: MR TODD & MRS SARAH MOSELEY
ADDRESS: 210 MAIN ARM ROAD
MULLUMBIMBY NSW 2482
LOT 9
DP 606129
PARISH OF BILLINUDGEL
COUNTY OF ROUS

PARAMETER DESIGNS
SONIA MACCOURT
11 Poplar Avenue
CABARITA BEACH NSW 2488
MOBILE: 0438 647 942
sonia@parameterdesigns.com